



ENERGY SAVING PRODUCTS

AIR CONDITIONING, HEATING, AND REFRIGERATION

INDEX

AC Leaf & Debris Protector	45	Heat Guns, Flame Guardian	50
Air Switches	84-87	High Pressure Control Hose And Assembly Kit	65-68
Anti-Windmill Brake	13	Hose, Garden	62
Bottles, Industrial Spray	58-61	Humidifier Water Pads	42
Brass Compression Fittings	35	Ice Scoops	9
Brushes, Schaefer	69-83	Light Bulbs	57
Bull's-eye Nozzle	46	Li'L Popper	11
Calipers	16	PB Blaster	6
Caulking Guns	12	Grease, Bearing / General / Food Grade	3
Caulk, Butyl	3	Nut Driver Tool (Z-Tool)	17
Cement, Wet/Dry Roof	6	Old Switcheroo	10
Compression Sprayers		Heresite Touch-up Spray	36
Acid Blaster, 2 Gal	58	High Heat	36
Acid Blaster & Big Shot		Industrial Maintenance	36
Replacement Parts	58	Pin Extractor Tool	17
Tommy Gun, 2 QT	59	Polyurethane Sealant Vulkem 116	2
Tommy Gun Replacement Parts	59	Power Extension Cords	57
Tommy II, 48 oz	59	Pumps	
Chiller Builder Kits	91-95	Acid Pumps	7
Core Gripper	17	Drill Pump	7
Couplings		Unit Disposal Labels	46
Raychem	21	ESP High Pressure Control Hose and Assembly Kit	65
Easy Levelers	11	Refractometer	48
Expanding Hose	62	Fire Stop	5
Fan Blade Pullers	13	Shop Cloths	40
Fire Stop	5	Sight Glass Tool	18
First Aid Kits	47	Silicone	
Flame Guardian	50	ESP 8732	1
Flowmeters	19	ESP 8736, Hi-temp	1
Foam, Expanding, Fire Stop	5	ESP AC&R	1
Four Way Key	16	XtraBond	2
Funnels, Chemical Transfer	15	Smoke Testers	44
Furnace Magnet	10	Solenoid, Humidifier	43
Fuses, Bussmann	51-55	Spray Bottles	58-61
Fuse Puller, Bussmann	55	Stretch Straps	14
Gasket Book, Finny's	34	Sure Temp Thermometer	45
Gasket Scraper	13	Switches, Air	84-87
Glue		Tank Carriers	18
Insulation Adhesives	8	Tape, Teflon Thread Seal	9
PVC Cement, Primer, Cleaner	8	The Little Black Box	10
Grease Gun, Plews	12	Thermo Plug	49
Glycol Refractometer	48	The Old "Switcheroo" / Furnace Magnet	10
Hand Cleaners & Towels	39-40	Thermostat Covers	63
Heat Blocker, Reusable	50	Tool Light Flash Light	56

Transition terminals	56
Tubing Clamps	89
TXV Power Head Wrench	16
Unit Disposal Labels	46
Valves	
Combustion Intake Alternate	10
Condensate Blow out	20
Compressor Pad Valves	30
Rotolock Valves	26-33
Brass Compression Fittings	35
Solenoid	43
Teflon O-Ring	34
Y-Strainer, Bronze	22
Y-Strainer, Plastic	19
KITZ	
Ball / Water	23
Gate / Water	23
Gas	22
Vulkem 116	2
UHS Solenoid	43
UHS 99	43
Vibration Absorbers	88
XtraBond 150	2
6 'N1 Wrench	14
Absorbent Pads	4
Wago Connectors	54
CO2 Cartridges	25
Oil Nozzle Tool	15
Drain Line Gun	25
Hex Revolver	18
Board Removal Tool	18
Quick Blast	20
Line Drive	20
Flex Connect	24
Rubber Couplings	24
PPE	37-38
Gloves	37
Coveralls	38
Shoe Covers	38
Contractor Trash Bags	40
Buckets and Accessories	41
ATC Fuses, Bulk	53
Vent Screens	63
Mini Split Fittings	63
HVAC Service Center	64

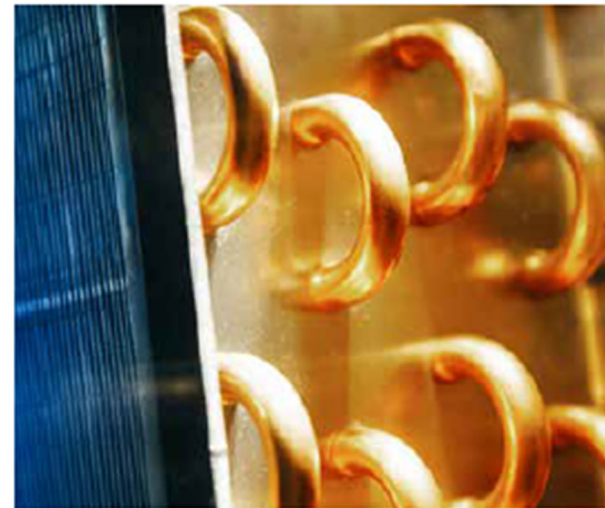

8732 Premium 100% Silicone

8732 Premium 100% silicone has exceptional adhesion and sealing qualities. This product meets USDA, FDA, UL, and NSF and has -40° to +450° F range. For general purpose refrigeration, air conditioning and heating applications. Available in 10.3 oz. cartridges or 3 oz. squeeze tube, individually boxed in clear, white, aluminum, or black.



8732 C, W, A, B 10.3 oz cartridge or 3 oz squeeze tube
Quantity 6 Per Box

8736 Hi-Temp Silicone

8736 Hi-temp silicone is also available, with use range of -85° F to 500° F (intermittent to 600° F, red only.)



8736R
10.3 oz cartridge or 3 oz squeeze tube
Quantity 6 Per Box

AC&R Silocone

AC&R New low cost 100% silicone has exceptional adhesion and sealing qualities. This product meets USDA, FDA, and has -40° to +450° F range. For general purpose refrigeration, air conditioning and heating applications. Available in 10.3 oz. cartridges in clear, white, aluminum, or black.



ACR C, W, A, or B, 10.3 oz.
Quantity 6 Per Box

XtraBond 150 RTV Silicone



XtraBond®150 a one component, permanently flexible, RTV (Room Temperature Vulcanizing) mildew-resistant silicone sealant that is the industry standard. The product's tough chemical resistance makes it a worry-free solution for a wide range of applications. Clear.

- Approved for Cultured Marble
- Excellent Adhesion to Glass
- Window & Door Approved
- Easy to Gun, Easy to Tool
- Non-Sag & Slump
- Non-Paintable



XB150
Quantity 24 Per Box

XtraBond 250 RTV Silicone



XtraBond®250 anti-microbial formula is NSF approved and FDA compliant, so it can be used confidently around food applications. Its resistance to moisture makes it ideal for use in high moisture areas such as marine, baths, and walk-in coolers.

- Consistent Gunability & Tooling
- Approved for Cultured Marble
- Anti-Microbial Formula
- FDA/USDA Compliant
- Excellent Adhesion
- Non-Paintable



XB250
Quantity 24 Per Box

VULKEM 116

Vulkem 116 is a textured, single-component, moisture-curing, gun-grade polyurethane sealant. Vulkem 116 is an excellent general-purpose sealant designed for use on poured and precast concrete, masonry work, window and door perimeters, and similar types of construction joints. Available in Gray, White, and Bronze.

VM116G, 10.3 oz.
VM116W, 10.3 oz.
VM116BZ 10.3 oz.
Quantity 30 Per Box



ESP Butyl Caulk



An inexpensive sealant used as perimeter seal, or capping around windows, doors, masonry or metal to metal applications. Used extensively in refrigerated cases, walk-in cooler doors by the fast food and convenience store market. Available in White and Gray.

7757WC White - Quantity 12 Per Box
7757GC Gray - Quantity 12 Per Box

Mobil Grease Polyrex "EM"



Super-premium Mobil Polyrex EM Series grease is specially formulated for electric motor bearings. The advanced thickener formulation and proprietary manufacturing techniques provide improved bearing performance and protection for long electric motor life.

EM Blue - Quantity 10 Per Box

Mobil Grease "EP"



Mobil Premium Lubricating Grease is a lithium thickened grease containing oxidation and corrosion inhibitors. It is suitable for lubrication of high speed ball and roller bearings found in motors, saws, spindles, generators, fans, and squirrel cages. Superior water resistance. Meets GM spec 7830695, 998537, and Detroit Diesel Corp. 1Y12 spec. - 30° to 350° max exposure. Available in 14.1 oz. tubes.

EP2- Quantity 10 Per Box

Mobil Grease XHP222 / FM222



Mobil Extended High Temp Service is a suitable bearing grease providing water resistance and corrosion protection for industrial, construction and marine service. Available in 14.1 oz. tubes.

XHP222, 14.1 oz- Quantity 10 Per Box
FM222, 14.1 oz- Quantity 10 Per Box



Mobil Red Lithium Grease

This is an advanced full synthetic grease formulated with a proprietary blend of high-performance synthetic base stocks and a lithium complex soap thickener. The thickener system provides a high dropping point, while additives impart excellent extreme-pressure properties and resistance to water wash, rust and corrosion. The proprietary blend of high-performance synthetic base stocks used in Mobil 1 Synthetic Grease gives reliable lubrication over wide temperature ranges -50 C (-58 F) to 246 C (475 F).

121071 (10/cs)



Absorbent Pads

Perfect for oil spills or placing under vacuum pumps when changing oil. These pads and rolls are constructed of two layers of fine fiber polypropylene and are ultrasonically bonded around a high-loft meltblown core. 15" x 17"

ABSP25 - Pack of 25 pads



FireStop Foam

Great for residential applications. Foam is better than conventional fire-block products at blocking smoke & flames, and has proven cost effectiveness due to easy application & excellent yield rate as opposed to standard caulks and fiberglass. Orange in color.

P30033 12 OZ. (12/cs)



Expanding Foam

This foam is a low-pressure, one-component, polyurethane foam sealant is a moisture-cured, multipurpose sealant designed to seal and fill small cracks and voids, creating a tight barrier against noise, moisture and air infiltration. HandiFoam® Sealant is UL GREENGUARD Gold Certified, contributing to healthier indoor environments.

P30002 - 12 OZ. (12/cs)

P30181 - 24 OZ. (12/cs)



FireStop

This is a latex based, high solids firestop caulk. This material, when properly installed, effectively seals penetration openings in wood frame construction against the spread of fire, smoke and combustion byproducts. It is a single stage intumescent. When exposed to elevated temperatures, WF310 expands rapidly to seal off voids left by the burning or melting of combustible materials.

WF310 - 10.1 OZ. (24/cs)



PB B'laster

B'laster PB Penetrating Catalyst is a powerful, concentrated penetrant that frees stubborn rusted or immobilized parts by releasing the surface tension that causes them to stick. PB magnetically creeps up, around and into tight, hard-to-reach cavities, then converts into a high lubricant, loosening troublesome nuts, bolts, rusted joints, pipe threads and other frozen parts in record time! B'laster PB's non-evaporating formula then stays on the surface of the part to protect against rust and corrosion. 16 oz. aerosol.

16-PB-DS - Quantity 12 Per Box



Acid Pump

The ESP compact submersible pump is designed to circulate strong acids and cleaning solutions. All parts are constructed of acid-resistant materials. Motor is protected by thermal overload. Powerful 300 GPH pump.

G325A



Wet/Dry Roof Cement

A heavy consistency mastic formulated with refined asphalt, filler, plastosizer, and solvent. All-purpose repair cement adheres to damp substrates. Remains soft and pliable through wide temperature fluctuations. Meets all requirements of ASTM D-4586-8-6, asbestos free.

WDRC 1 Gal - 6 / box

WDRC 10.3 oz. - 12 / box



ESP NEW Replacement Pump

Drill pump for Glycol/Oil/Any Fluid.

PUP62 and PUP63

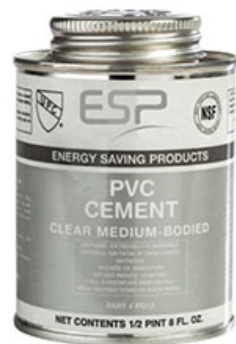

PVC Clear Glue

This medium body solvent cement is used to join PVC pipe and fittings for potable water and drain, waste and vent systems. Recommended for PVC Types I and II, schedule 40" to 8" and schedule 80" to 6" diameters. ASTM D-2564. Available in 1/4 and 1/2 and 1 pint cans with dauber.

PG14 - 24 / box, PG100 - 12 / box



ABS, PVC, CPVC All Purpose Glue

This clear regular bodied cement can be used on ABS, PVC schedule 40 and 80 Type I and Type II, gas pipe, conduit and CPVC schedule 40 up to 4" in diameter. Set time 45 seconds. Available in 1/4, 1/2, and 1 pint containers.

AP14 & AP12 - 12 / box



Purple Primer

Softens and prepares PVC pipe and fittings for gluing. Use for potable water and drain, waste and vent systems. ASTM F656.

PP14 (1/4 pint), PP12 (1/2 pint) 24 / box

PP100 (1 pint) containers, all with dauber - 12 / box



Clear Cleaner

Cleans and prepares PVC, CPVC and ABS fittings for gluing.

PC14 (1/4 pint), PC12 (1/2 pint) - 24 / box

PC100 (1 pint) - 12 / box



Insulation Adhesive

Used by contractors nationwide as the premier insulation adhesive. Is now specified by a major insulation tubing manufacturer to be used on their products. Color: Amber. Viscosity: 200 - 300 CPS. Odor: solvent when wet / none dry. Bonding range: to 20 minutes. CAUTION: Extremely flammable. Avoid open flame or spark. Apply in well ventilated area.

CC12 (1/2 pint) - 24 / box CC100 (1 pint) - 12 / box

ESP Teflon Thread Seal Tape



Teflon thread seal tape offered in both .0035 and .0032 thick tape manufactured by Dupont. Both meet MILT-27730A specs, are recognized by NSF and are approved by NASA. .0035 Tape is UL approved. Available in 260" and 520"

TT260 or TT520 for 1/2", .0032 mil and .70 density- Packed 100 /box or 10 /sleeve
TTUL260 or TTUL520 for 1/2", .0035 mil, .90 density Both packed 144 /box

Three Quart Scoops

Available for ice or dry chemicals. 14 1/2" high x 6" wide x 6" deep polypropylene in white only.

PS621



The Little Black Box



DETAILS

- Converts 120V to 24V check systems
- Designed for the lab, available to the contractor
- Perfect for parts counter control checking
- Professional 40" silicone test leads with point probes, and interchangeable alligator clip extensions
- 24v manual reset overload protection
- Lighted 120v power switch
- High strength magnetic backing grips metal surfaces
- One Year Warranty



VP24

LI'L POPPER Voltage 24V



Li' L Popper control circuit breaker saves the technician dozens of blown fuses while he diagnoses control circuit failures. Simply plug the leads in to the ATC fuse receptacle on the board, and manually reset the Li' L Popper each time the breaker blows. Has a quick setting thermal cut out. Self adhering backing allows the contractor to leave the unit on the job site overnight if he is out of fuses. Available in 3 amp, 5 amp, 10 amp, 15 amp, and 20 amp. Alligator clip versions are available.

POP3, POP5 for residential or commercial amp applications or POP10, POP15, POP20 for microwave and appliance applications POP3Z, POP5Z for Alligator clip versions



The Old Switcheroo

The Old Switcheroo is a heavy duty industrial magnet designed to hold down pop out switches while the technician trouble shoots the furnace or air handler. Two wings will reach out to switches that are set apart from a flat metal surface. A must in the tool box. Ask for free counter display with tri-folds.

FF75

FF75 Display



Easy Levelers

Revolutionary furnace leveling system created for the perfectionist. Four sturdy bolt-adjusted leg extensions supplied with mounting materials. Simply turn the lag bolted insert clockwise or counter clockwise to raise or lower each corner of the furnace. Supports up to 400 lbs Adjustment from 2 3/4" - 4" Height.

Free display, holds eight packages.

Patent #7,137,604

EL10

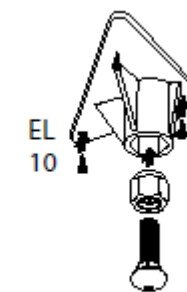
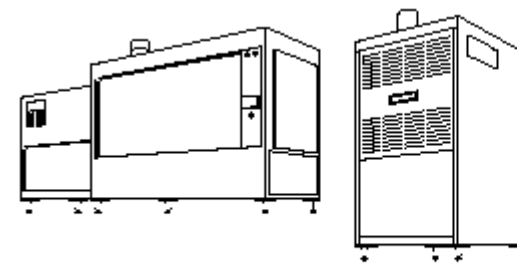

EL10 Display



N-Take 2

This unique device is installed within the draft induction supply line in between the outdoor intake and the furnace. When a blocked intake would normally result in a no heat call, and a shut down furnace, the N-Take 2 opens due to a slight vacuum inside the pipe. Not to be used as a primary combustion inlet. Alternate only.

Free display pictured here.

NT02

NT02 Display



Caulking Guns



Durable, high quality, and heavy duty. Made of heavy gauge metal with positive action plunger rod.

012-DC

Plews Grease Guns



Meet the toughest grease guns around. The all new grease gun line from Plews. These guns have been completely redesigned and incorporate advanced features that are unmatched in the industry.

Constructed of heavy duty steel and finished in rugged baked enamel and tough zinc plate. Every feature of these grease guns has been engineered for the rigors of professional use. Lifetime warranty.

30200

Grease Hose



There are 1/8" NPT male fittings on each end. Meets U.S. Government mil-spec.

10-212 for 12" and 10-219 for 18"

Fan Blade and Blower Wheel Tools



Fan blade and blower puller tool by ESP offers a simple and easy solution to locked fan blades and blower wheels. Will not damage blower or blade, so the unit quickly pays for itself.

FB100

Wilde Gasket Scraper



Heavy-duty 11" industrial gasket scraper for quick and easy removal with a one inch face and 1 1/2" face.

GS-516 1" Face

GS-516 Wide 1 1/2" Face

Anti-Windmill

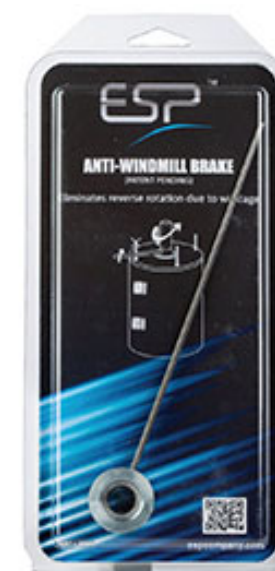

This patented device slips over the motor shaft and will prevent the motor from rotating in the opposite direction due to windage. Most motors will start and continue to run in the opposite direction if the reverse rotation is severe enough, causing premature motor failure. Fits shaft sizes 1/2" and 5/8".

AW12 or AW58

- Wrong rotation will cause the rod to strike thru-bolt, which will stop the shaft from turning
- Shaft will rotate the correct direction freely
- NOTE: This device will stop windmilling in the wrong rotation only

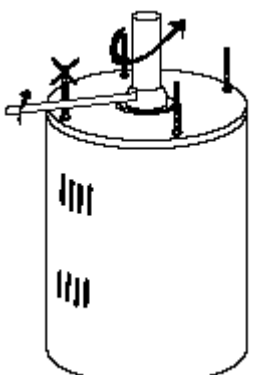

6 'N 1 Lug Wrench



- Offers both hexagon and square sockets
- Four nut drives sized 1/4", 5/16", 11/32", 3/8"
- Two squares sized 3/16" and 1/4"
- Use as a handle for 1/4" extension drives
- Fits MC and B acetylene tanks
- Fits service valves
- High-quality vanadium tool steel
- Easy grip round handle
- Pocket sized
- Lightweight and compact
- All drives will accept long screws
- Individually bagged with card & hanging tab

LW601

Chemical Transfer Funnels

Avoid any potential spills of harmful chemicals during transfer. Available in 1/2 Gallon. with brass filter screen, Part # 240117, or in a 1 gallon size (with screen).



240116 (1 gal.) or 240117 (64 oz.)



Rubber Stretch Straps



The specially compounded rubber resists sun and weather to last indefinitely. Tensile strength to 50 pounds. Made In the USA Available in 10", 15", 21", 31" and 41"

RS10, RS15, RS21, RS31 or RS41



Nozzle Buddy

The easiest way to change oil nozzles

40437



Pocket Caliper

Stainless steel 3" caliper, 1/32" and millimeters, inside, outside graduations.

132ME



Utility Vernier Caliper

0-5" range, mm and 16th graduations.

722

For 0-4" Stainless order 729

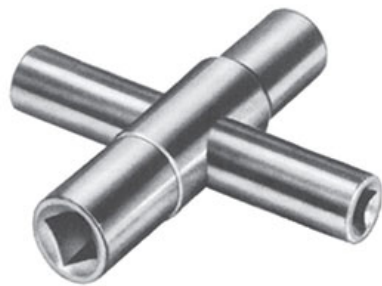

Four Way Key

Fits stopcocks, sillcocks, and valves. Sizes are 1/4" to 9/32" and 5/16" to 11/32" Precision machined plated steel.

FW1701

TXV Power Head Element Wrench

This handy wrench fits most Sporlan and Alco power head elements for easy removal and replacement.



PH10



Z-Tool

This handy dual nut driver has 1/4" and 5/16" pivoting sockets to reach the most difficult angles and tightest screw locations.

ZT10

ZT10-Bulk 25/Box

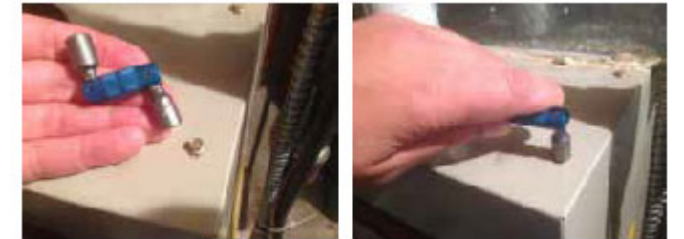

Pin Extractor Tool

This handy tool will help to pop out Molex and Amp Electrical pins in igniter and other controls.

PE44



Core Gripper

Just push in the base to extend four gripper fingers and the spring release grabs the core so that it can be turned out and removed.

CGR10





Sight Glass Tool

The ESP sight glass tool slides easily into the notches of a scroll compressor sight glass and easily helps to extract the sight glass with a crescent or socket wrench. 1" diameter.

SGRT



Board Removal Tool

Remove boards from their standoffs easily. Dual sided tool easily compresses both sizes of standoffs seen in the HVAC/R industry. A must have for the truck.

BRT10



The Hex Revolver

Featuring 6 color-coded screwdriver holder for easy sorting and quick identification of bits and chucks. Keeps frequently used driver bits within reach. Quick-release design for effortless bit changes.

BHI



Rhino Tank and Compressor Tote

The Rhino tank and compressor tote allows the user to easily pick up nitrogen, CO2, and oxygen 20 and 40 lb cylinders, along with all hermetic compressors with lift tabs

RH10



ESP Flowmeters



Ground water-sourced, heat pump applications. This high quality polycarbonate bodied flowmeter has 3/4" MPT nylon threaded connections and 1-10 GPM capacity.

LDF357N- 3/4" MPT 2-10 GPM

LDF359N-3/4" MPT 2-18

C-1K55-A020 King Glass/Brass Liebert Replacement 1" MPT



Pro-Line 1" NPT-Solenoid Valve

Normally closed 24V or 115V slow closing 150 psi solenoid valve for use on ground water source heat pumps. Maximum operating temperature 110°F.

HP215 or HP510-115

ESP BronzeY-Strainers



Used primarily for all water applications. Working pressure: 300psi W.O.G.; 150psi W.S.P. 80 Mesh screen, 1/4" thru 3/4" sizes.

BY12 - 8 / box & BY34 - 6 / box

ESP Plastic Y-Strainers



Used extensively in the ice machine and water cooler industries. Size 3/8" Manitowoc part# 136067-9; Scotsman part # 16-0162-00.

PY38



QuickBlast

The QuickBlast is the easiest way to service condensate lines. Once installed, simply turn the ball valve closed, supply pressure upstream, then downstream, and turn the ball valve back open. No additional tools, no leaks, no restricted flow - just a quick and easy way to clear lines.

QBI

Quick Blast Adapter

Connect a drain line gun directly to a Quick Blast or Line Drive.

QBA

Line Drive

This 3/4" x 3/4" slip on condensate pan blow out valve is a patented one of a kind item. No more buying little cartridges and trying to find the end of drain lines in the dark. Simply install this unit exiting the evaporator in your residential or commercial AC system, and hook up a 1/4" charging hose to the valve and the other end to your CO2 or Nitrogen tank. Turn the valve one way, and blow out the line. Turn it the other way, and remove any blockage inside the coil.

LD10 (8 per box)



Raychem Aluminum to Copper Refrigerant Coupling

Raychem tube couplings, repair leaks in aluminum or copper/aluminum joints.. When heated with a propane torch, this one-piece coupling shrinks to join and seal refrigerant tubing. Unlike traditional joining methods such as welding and brazing, where joint quality depends on preparation and technique, Raychem couplings create strong, reliable joints time after time. Joining copper or aluminum in hard-to-reach places. Trouble-free reliability. One-piece construction eliminates the problem of parts that vibrate loose after assembly. And Raychem tube couplings are stronger than the tubes they connect. They withstand pressures up to the burst pressure of the tubing, pullout forces in excess of the typical yield strength of the tubing, and vibration fatigue up to the failure of the tubing.

Easy to install. The only tool required is a propane torch. No flux, no solder, no wrenches are needed. Merely slip the coupling over the tube ends, and heat. A colored band at either end changes color to signal when the installation is complete. (This takes approximately 20 seconds for a 3/8" coupling.) And, because there is no residue, there is no need to flush the tubing. Now it is fast and easy to make these permanent, reliable joints even in hard-to-reach places.

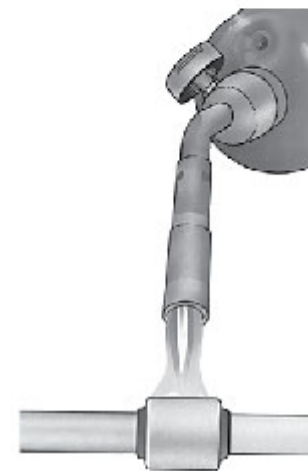

PCL 1/4, PCL 3/8, PCL 1/2, and PCL 5/8 - 10 / box

PCL RAYCHEM DISPLAY, N/C.- 10 / box

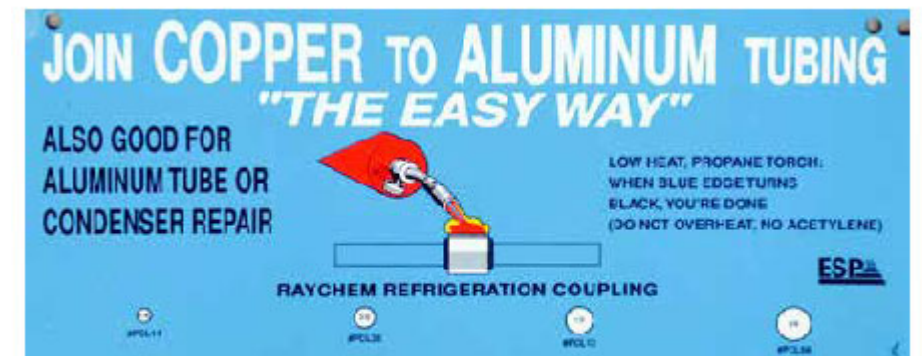

"FREE DISPLAY"

KITZ

Code No.15 (Fig. AKYU)



Class 150 Y-Pattern Strainer

Y-Pattern Strainers provide protection for equipment having internal moving parts. Has blow-out outlet for easy clean-out, threaded cap for easy removal. Bronze body and Type 304 stainless steel screen. NPT threaded ends or solder joint ends.

Working Pressure
300 psi. W.O.G. non-shock
150 psi. W.S.P. saturated

Test Pressure
Shell 450 psi. hydrostatic

Dimensions		inch					
Size		1/4	3/8	1/2	3/4	1	1-1/4
L (IPS)		2.76	2.76	3.15	3.94	4.53	5.31
L (C x C)		—	—	3.15	4.13	4.92	5.71
H		1.73	1.73	1.93	2.28	2.80	3.19
Drain Port		1/4	1/4	1/4	1/4	1/2	1/2
A		1.41	1.41	1.57	1.96	2.52	2.95
B		0.59	0.59	0.70	0.90	1.14	1.42

Code No.16 (Fig. CYU)



15-014, 15-038, 15-012, 15-034, 15-100, 15-114

KITZ Code No. 15/16

Code No.60 (Fig. NO. AKGZH)
Threaded Ends



Gas Ball Valve

- Manual operated gas shut-off valves for appliances, appliance connector valve and hose end valves. The following agencies have certified these valves: AGA, CGA, ANSI, and ASME
- Forged Body Construction for Greater Strength
- Blowout-Proof Stem Design
- High Cycle Life PTFE Seats and NBR Seal
- Quarter Turn Open/Close Operation
- Positive Shutoff with Zero Leakage
- Rated for temperatures from -20° F to 125° F at pressures from 1/2 – 125 psi.

Wing Operator - KITZ Code # 60 (AKGZH)

Square Operator - KITZ Code # 60 SQ (AKGZHSQ)

60-012 or 60-034

KITZ

Code No.07 (Fig. AKFS)



Class 125 Brass Gate Valve

Forged Brass Gate Valves have screwed-in-bonnet, non-rising stem, solid wedge disc, integral seat, NPT threaded or solder joint ends

** high tensile strength. Non-rising Stem permits installation where head space is limited.

Dimensions		inch				
Size		3/8	1/2	3/4	1	1-1/4
L (IPS)		1.50	1.65	1.85	1.97	2.36
L (C x C)		—	1.77	2.36	2.76	3.03
H		2.95	2.95	3.39	3.82	4.61
D		1.97	1.97	2.17	2.36	2.76

Code No.08 (Fig. CFS)



07-012, 07-034, 07-100

KITZ Code No. 07/08



KITZ

Code No.58 (Fig. AKZA)



600 WOG "Full Port" Brass Ball Valves

Full Port Brass Ball Valves are two-piece construction with a chrome plated brass ball, blowout-proof stem, PTFE seats and double 'O' ring stem seal. Quick quarter-turn for easy operation. For use in plumbing and light industry applications. Standard NPT end connection.

Working Pressure
600 psi W.O.G.
150 psi A 300° F

Test Pressure
Shell 900 psi. hydrostatic
Seat 80 psi. air

Dimensions		inch					
Size		1/4	3/8	1/2	3/4	1	1-1/4
Bore		0.39	0.39	0.59	0.79	0.98	1.26
L (IPS)		1.57	1.61	1.93	2.20	2.56	2.99
L (C x C)		1.73	1.81	2.13	2.87	3.47	3.94
H		1.42	1.42	1.54	1.73	1.93	2.17
D		3.15	3.15	3.15	5.12	5.12	5.12

Code No.59 (Fig. CZA)



58-014, 58-038, 58-012, 58-034, 58-100, 58-114

58-112, 58-200

KITZ Code No. 58/59

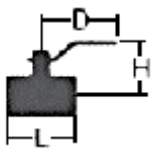

FlexConnect Couplings and Adapters

Available in a variety of sizes, the FlexConnect line is a no adhesive way to couple and adapt PVC lines to one another. 3/4" is especially convenient in the HVAC industry for condensate line service or repair



- Flexcon34-6** **6 pack of 3/4" PVC COUPLINGS**
- Flexcon-BULK** **Box of 100 3/4" PVC COUPLINGS**
- FlexB-6** **6 pack of 3/4" to 1/2" BUSHINGS**
- FlexCon1** **1" COUPLING**
- FlexCon125** **1.25" ADAPTER**
- FlexCon150** **1.5" ADAPTER**
- FlexCon125150** **1.25" to 1.5" ADAPTER**
- Flexcon2** **2" COUPLING**
- Flexcon3** **3" COUPLING**
- FlexCon23** **2" to 3" ADAPTER**

CO2 Cartridges

Compatible with all industry drain line guns. 16 gram cartridges available both threaded and unthreaded; 12 pack in merchandise packaging or 100 in bulk. 20 gram available unthreaded in a 12 pack.



- CO2-12 - 12 pack unthreaded 16 gram**
- CO2-100 - 100 pack unthreaded 16 gram**
- CO2-12T - 12 pack threaded 16 gram**
- CO2-20-12 - 12 pack unthreaded 20 gram**

Drain Line Gun

Accepts all 16 gram cartridges, threaded or unthreaded.



DLG-1

Drain Line Gun XL

Accepts 20 gram CO2 cartridges.
This gun packs an extra punch!



DLG-2

ROTOLOCK VALVES, ADAPTERS, and ACCESSORIES

ESP offers the fullest line of rotolock valves, adapters, and accessories and a complete cross reference to most Copeland and Alfa/Standard Refrigeration parts. All valves and adapters are available with or without O-ring. If you purchase without, the TR-10 Teflon O-Ring kit contains three each of ALL sizes.

Part Number Key: E.g. H 038 OD 034 T

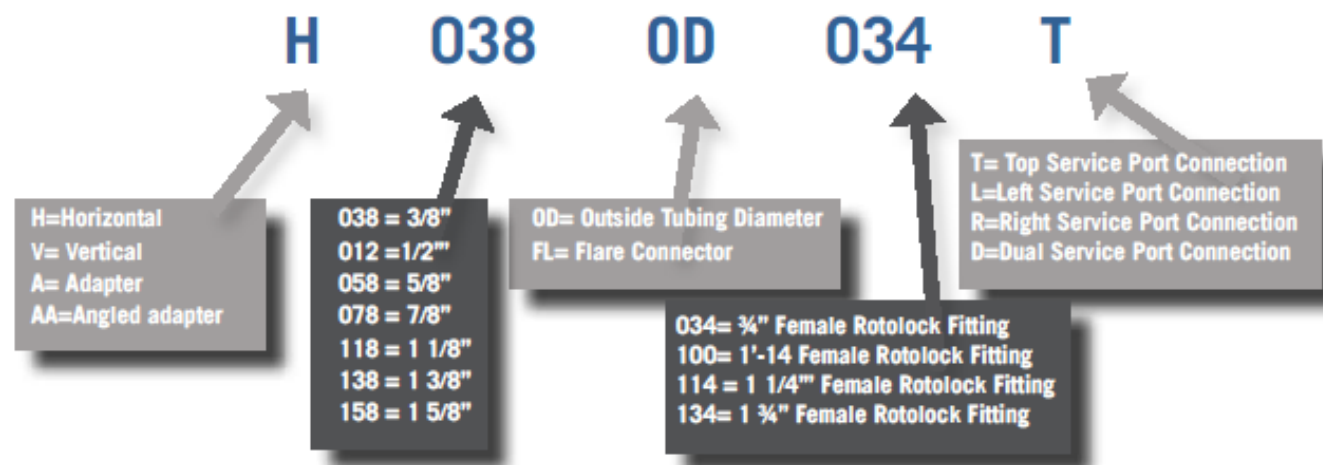

Service Port Connection Orientation

*Note Service Port connection left and right orientation determined by placing the valve with stem up, rotolock fitting facing up. This is a dual connection, with a upper left and lower right service port.



HORIZONTAL ROTOLOCK

ESP #	ESP WITH O-RING	COPELAND	ALFA-LAVAL #
TOP PORT			
H038FL034T	H038FL034T-O		H03FT
H038OD034T	H038OD034T-O		
H012FL034T	H012FL034T-O		
H012FL100T	H012FL100T-O		H04FT
H058FL100T	H058FL100T-O		HOSFT
H0120D100T	H0120D100T-O		H04ST
H0580D100T	H0580D100T-O		HOSST
H034OD114L	H034OD114T-O		
H0780D114T	H0780D114T-O		H07ST
H1180D114T	H1180D114T-O		H09ST
H1180D134T	H1180D134T-O		H11ST
	H138OD134T-O	998-0510-66	
LEFT PORT			
H038FL034L	H038FL034L-O		H03FL
H038FL100L	H038FL100L-O	998-0510-58	
H012FL100L	H012FL100L-O		H04FL
H058FL100L	H058FL100L-O		HOSFL
H0120D100L	H0120D100L-O		H04SL
HOS80D100L	HOS80D100L-O		HOSSL
H034OD114L	H034OD114L-O	998-0510-38	
H0780D114L	H0780D114L-O		H07SL
H1180D114L	H1180D114L-O	998-0510-51	H09SL
H1180D134L	H1180D134L-O		H11SL
	H158OD214L-O	998-0510-68	

HORIZONTAL ROTOLOCK VALVES



ALFA-LAVAL #	ESP #	ESP WITH O-RING	COPELAND
DUAL PORT			
	H038OD100D	H038OD100D-O	998-0510-97
	H038FL100D	H038FL100D-O	
	H038FL114D	H038FL114D-O	998-0510-42
	H038OD114D	H038OD114D-O	998-0510-43
	H012FL034D	H012FL034D-O	
	H012FL100D	H012FL100D-O	998-0510-40
	H012OD100D	H012OD100D-O	998-0510-98
	H012OD114D	H012OD114D-O	998-0510-44
	H058FL100D	H058FL100D-O	998-0510-41
	H058OD114D	H058OD114D-O	998-0510-45
	H034OD114D	H034OD114D-O	
	H078OD100D	H078OD100D-O	998-0510-89 & 52
RIGHT PORT			
H03FR	H038FL034R	H038FL034R-O	
H04FR	H012FL100R	H012FL100R-O	
H05FR	H058FL100R	H058FL100R-O	998-0510-56
H04SR	H0120 D100	H0120 D100-O	
H05SR	H058OD100R	H058OD100R-O	
		H078OD100R-O	998-0510-52
H07SR	H078OD114R	H078OD114R-O	998-0510-39 & 90
	H078OD134R	H078OD134R-O	
H09ST	H118OD114R	H118OD114R-O	998-0510-99
		H118OD134R-O	998-0510-02
	H138OD134R	H138OD134R-O	998-0510-46
		H158OD134R-O	998-0510-66



**VERTICAL
ROTOLOCK**

ALFA-LAVAL #	ESP #	ESP WITH O-RING	COPELAND
TOP PORT			
V03FT	V038FL100T	V038FL100T-O	998-0510-58
V04FT			
V05FT			
V04ST	V0120D100T	V0120D100T-O	
V05ST	V0580D100T	V0580D100T-O	
V07ST	V0780D114T	V0780D114T-O	
V09ST	V1180D114T	V1180D114T-O	
V11ST	V138D134T	V138OD134T-O	
LEFT PORT			
V03FL			
V04FL			
V05FL			
V04SL	V0120D100L	V0120D100L-O	
V05SL	V0580D100L	V0580D100L-O	
V07SL	V0780D114L	V0780D114L-O	
V09SL	V1180D114L	V1180D114L-O	
V11SL	V130D134L	V130D134L-O	
H09SL	H1180D114L	H1180D114L-O	998-0510-51
H11SL	H1180D134L	H1180D134L-O	
		H158OD214L-O	998-0510-68
DUAL			
	V0120D100D	V0120D100D-O	
	V038OD034D	V038OD034D-O	
	V0580D100D	V0580D100D-O	
	V0780D114D	V0780D114D-O	
	V1180D114D	V1180D114D-O	
RIGHT PORT			
V03FR			
V04FR			
V05FR			
V04SR	V0120D100R	V0120D100R-O	
V05SR	V0580D100R	V0580D100R-O	
V07SR	V0780D114R	V0780D114R-O	
V09SR	V1180D114R	V1180D114R-O	

PAD VALVES



Two Bolt Flare Pad Valve



Two Bolt Sweat Pad Valve

ESP #	ESP WITH O-RING	COPELAND	ALFA-LAVAL #
TWO BOLT PAD VALVE			
PV012FLLH	2B12FL158L	998-0510-28	
PV58FLLH	2B58FL158L	998-0510-29	
PV02FLLH	2B12FL158R	998-0510-30	
PV058SWLH	2B58FL158R	998-0510-31	
PV038FLLH	2B38FL158L	998-0510-32	
PV014FLLH	2B14FL158L	998-0510-33	
PV058SWRH	2B58OD158R	998-0510-34	
PV038SWRH	2B38OD158R	998-0510-35	
PV038SWLH	2B38OD158L	998-0510-36	

SIGHT GLASS



ESP #	ESP WITH O-RING	COPELAND	ALFA-LAVAL #
SIGHT GLASS			
SG12			SG12
SG34			
SG10			
SG114			
SG20			
3/4"			

ADAPTERS



Angle Adapter Steel



Male Adapter Brass



Male Adapter Steel



Straight Adapter



Pad Adapter

ESP #	ESP WITH O-RING	COPELAND	AALFA-LAVAL #
STRAIGHT ADAPTER			
A0380D114	A0380D114-O		SA03
A0120D114	A0120D114-O		SA04
	A0120D100-O	998-0034-18	
	A058OD100-O	998-0034-17	
A0580D114	A0580D114-O		SA05
	A034OD114-O	998-0034-07	
A078D114	A078D114-O	998-0034-08	SA07
	A118OD114-O	998-0034-09	
A138OD134	A138OD134-O		SA11
	A118OD134-O	998-0034-10	
	A138OD134-O	998-0034-13	
	A138OD214-O	998-0510-11	
	A158OD214-O	998-0519-12	

ESP #	ESP WITH O-RING	COPELAND	ALFA-LAVAL #
MALE STEEL ADAPTER			
	MA038OS114-O	998-0034-14	
A012OD100M	MA012OS100-O	998-0034-15	
	MA058OD100-O	998-0510-16	
	MA034OD114-O	998-0034-01	
A078OD114M	MA078OD114-O	998-0034-02	
A118OD134M	MA118OD134-O		
ANGLE STEEL ADAPTER			
AA038OD100	AA038OD100-O		AA03
AA012OD100	AA012OD100-O		AA04
AA058OD100	AA058OD100-O		AA05
AA078OD114	AA078OD114-O		AA07
AA118OD114	AA118OD114-O		AA09
AA138OD134	AA138OD134-O		AA11
MALE BRASS ADAPTER			
7000-186	7000-186-O		BA03X06
7000-187	7000-187-O		BA03X08
7000-190	7000-190-O		BA04X08
N/A	N/A		BA05X08
7000-188	7000-188-O		BA07X10
7000-193	7000-193-O		BA09X10
7000-196	7000-196-O		B09X14
7000-200	7000-200-O		BA11X14

Rotolock Caps



Plastic Rotolock Caps



Steel Rotolock Caps

ESP #	COPELAND	AALFA-LAVAL #
ROTOLOCK CAPS		
3/4" rotalock cap, plastic (2/pk)		RC034-2
1" rotalock cap, plastic (2/pk)		RC100-2
1 1/4" rotalock cap, plastic (2/pk)		RC114-2
1 3/4" rotalock cap, steel (1/pk)		RC134-1



ESP #	COPELAND	AALFA-LAVAL #
FUSIBLE PLUGS		
212 -1/8"		PLUG-175
212 -5/8"		PLUG-265
281 -3/8"		PLUG-337
300 -1/2"		PLUG-300

Brackets

ESP #	ESP WITH O-RING	COPELAND	AALFA-LAVAL #
BRACKETS			
BR1			BR1
BR3			BR3
BR5			BR5
BR7			BR7
BR9			BR9
5A			5A
6A			6A
6B			6B
8B			8B
10B			10B
12B			12B
14B			14B
16B			16B

Teflon O-Rings

TR10-12 O-Ring Kit

ESP #	ALFA-LAVAL #	Description
TEFLON O-RINGS		
TR034-6	TS-24590	3/4 rotolock o-ring 6/pack
TR100-6	TS-24591	1" rotolock o-ring 6/pack
TR114-6	TS-24592	1 1/4" rotolock o-ring 6/pack
TR134-6	TS-24593	1 3/4" rotolock o-ring 6/pack
TR10-12	TR10	3 each, 3/4, 1" 1 1/4" and 1 3/4" o-rings



ESP delivers o-rings, o-ring kits, valve caps & kits, rotolock pad adapters, and gaskets.

GASKETS

Plus our gasket book—Finny's Gasket Book

This array of 36 different gaskets replaces most common gaskets used today in expansion and solenoid valves and pumps. This fine gasket material Garlock replaces old gaskets on Sporlan, Penn, Alco, Jackes Evans, Parker, Mueller, Hamilton Pax, Henry and Primore for a fraction of the price. Attractive counter pad with all 36 life-size gaskets available.

GB10



ESP Brass Compression Fittings



Brass compression fittings can be used with copper, aluminum, brass, and plastic tube. Compatible with a wide variety of liquids and gases such as water, air, and fuels. Listed with U.L. for flammable liquid. Manufactured for low and medium pressure tubing connection work where excessive vibration or tube movement is not involved. Not recommended for application using gaseous media.

Working pressure ranges:

PSI	Tube OD	Tube Wall (inches)
400	1/8	.030
400	3/16	.030
300	1/4	.030
300	5/16	.032
200	3/8	.032
200	1/2	.035

Available in most configurations from 1/8" thru 5/8". Sleeves, nuts, unions, tees, adapters, elbows and other specials available on request.

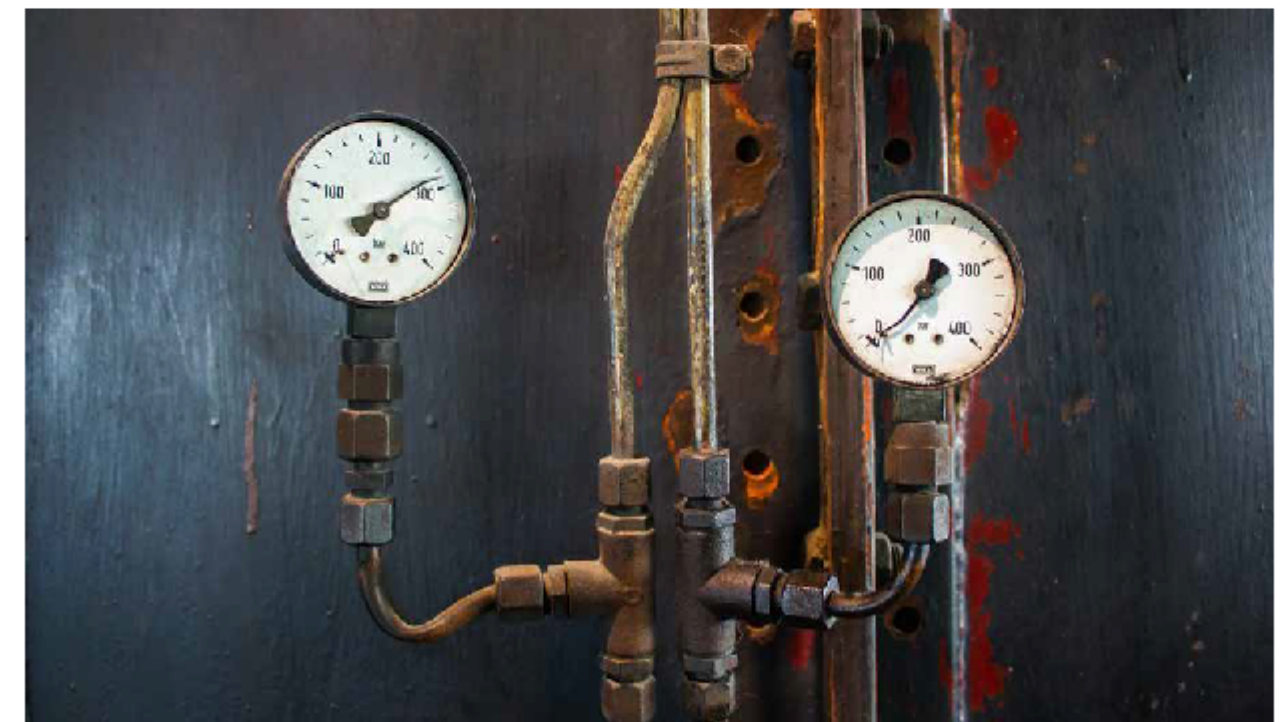



Heresite Touch-Up Spray

This VR-554T air dry phenolic heresite spray is the highest quality metal protective coating sold in the U.S. today. Can be used to protect any surface subjected to corrosive atmospheres, 12 oz. Can.

VR-554



Rustoleum Spray Paint

Available in a variety of colors. 12 oz. unless specified. General purpose paint adheres to a variety of surfaces including wood, metal, and plastic.

3838506 - Flat Black (6/cs)

3838508 - Glossy Black (6/cs)

3838509 - Dove Gray (6/cs)

3843043 - High Heat Black (6/cs)

3843110 - Safety Yellow (6/cs)

429762 - Safety Red (6/cs) (15 oz.)



Raven 7 mil Nitrile Black Gloves

Powder-free exam grade nitrile. Non-latex. Outstanding strength, wear and dexterity. Textured for enhanced gripping power. 7 mil thick. 100 gloves per box

66517 - Medium

66518 - Large

66519 - XL

66520 - 2XL



Raven 7 mil Nitrile Hi Visibility Gloves

Powder-free exam grade nitrile. Non-latex. Outstanding strength, wear and dexterity. Textured for enhanced gripping power. High visibility green color. 7 mil thick. 100 gloves per box.

66551 - Medium

66552 - Large

66553 - XL

66554 - 2XL



Derma-Tuff Nitrile Gloves

Powder-free exam grade nitrile. Non-latex. Outstanding strength, wear and dexterity. Textured for enhanced gripping power. 6 mil thick. 100 gloves per box.

66587 - Medium

66588 - Large

66589 - XL

66590 - 2XL

HPPE Knit Gloves - Nitrile Palm

13-gauge High Performance Polyethylene knit shell. Micro-foam nitrile coated palm. Comfortable and superior performance. Meets current ASTM F2992-15 Standard for Cut Level A5



6773-02 - Medium (12/cs)

6773-03 - Large (12/cs)

6773-04 - XL (12/cs)

6773-05 - 2XL (12/cs)

Heavy Duty Professional Coveralls

Microporous non-woven material with polyethylene coating. Comfortable cloth-like fiber. Full zipper front. Elastic wrist and ankle cuffs. Meet ASTM F903-10 Chemical Penetration test for Solvent Based Paints.



6952 - Medium (24/cs)

6953 - Large (24/cs)

6954 - XL (24/cs)

6955 - 2XL (24/cs)

6956 - 3XL (24/cs)

Waterproof Shoe Covers

Durable, waterproof CPE material. Textured surface for better grip. Easy to put on and remove. Elastic opening for secured fit. Keeps shoes, boots and worksites clean



6884-06 - 6 pairs

6884-40 - 40 pairs

Rough Touch
SCRUBS



Scrubs-In-A-Bucket

Scrubs-in-a-bucket provide fast, easy and effective hand cleaning with portability. Pumice performance without gritty residue. Can be used with or without rinse. Removes grease, graphite, and even tar 6 per box.

SB72. 72 sheets, 10-1/4" x 12-1/4"

SCRUBS DISPLAY AVAILABLE AT NO CHARGE SB72



SB30

30 sheet, tool-box size





Blue-Seamed Wiping Cloths

Heavy-duty blue seamed industrial cotton for any cleanup job. Available in 5 or 10lb. boxes.

WC05 (5lb.) or WC10 (10lb.)



Bad Ass Bags

42 gallon, 3 mil, black contractor trash bag with flaps. Essential truck stock

CTB25



Handy Bucket and Bucket Seat

Available with both a wire and rope type handle, this 5 gallon bucket is a cut above the rest. The bottom side of the bucket has a handle which gives you something to grip when carrying, dumping, or moving tools, condensate blow out, or whatever your bucket may contain. Great price, top of the line quality - Made in the USA



BUCKET-5GW - 5 gallon bucket with wire handle with ESP logo (10/box)

BUCKET-5GR - 5 gallon bucket with rope handle with ESP logo (10/box)

BUCKETSEAT - Rotating seat that pairs perfectly with bucket (White)

BUCKETLID - White bucket lid with rieke spout



Best Air Pro Water Pads

Best Air is the #1 selling humidifier water pad in the USA. These pads maximize humidity output and out perform all other pads. Our patented drip pattern, and 100% clay covered media is the difference. Replaces Aprilaire, Honeywell, Lasko, Hamilton, and Lennox.

A10PR, A12PR, A35PR



Universal Humidifier Solenoid

This universal solenoid can replace common units such as Aprilaire #4040, General's #990-53, Honeywell's #32001639-002, and the Skuttle #A01-0814-148 in 24V versions. The UHS will soon become an essential truck stock item. All appropriate fittings are included in the kit with a universal bracket. Flow can easily be reversed by removing two screws, turning the solenoid 180 degrees, and replacing the screws. 110V version is also available.

UHS24 or UHS120



UHS 99 Universal Humidifier Solenoid

UHS99

The UHS 99 can replace common units such as Aprilaire #4040, General's #990-53, Honeywell's #32001639-002, and the Skuttle #A01-0814-148 in 24V versions.

UHS99



ESP Smoke Emitters

Supplied in clean-to-handle cartridges and leave no visible residue. Smoke produced is easy to see and photograph if required. Oil-free smoke eliminates possible damage to decorations or equipment. Sizes are 45, 90, and 150 seconds 10/Box.

SE45, SE90, SE150

4 Minute and 8 minute smoke emitters

SE004 and SE008



The Sure Temp Product Thermometer

Is the least expensive device manufactured today to show exact product temperature in a case, reach-in or walk-in. The sensing probe itself is immersed in a glycol filled well that reacts to changes in ambient at the same rate as stored product. This assures the technician that he is reading internal product temperature and not surrounding air temperature.

The Sure Temp Thermometer is NSF certified and meets the criteria of Food Service.

Operating: Range is -40 degrees F to +180 degrees F. Dimensions are 1-5/15" X 6-7/8". Each unit comes with a bracket and screw for easy attachment to a rack or a panel. Each 10 unit case ships in an attractive counter display.

ST1236-31, (10/cs).



Superior Smoke Emitters

Superior® Classic Smoke Candles quickly and efficiently produce dense white smoke. The Superior® #1A Smoke Candle generates 4000 cubic feet of smoke in thirty seconds. The Superior® #2B Smoke Candle generates 8000 cubic feet of smoke in sixty seconds. The Superior® #3C Smoke Candle generates 40,000 cubic feet of smoke over a 3+ minute burn duration.

1A (12/BAG)

2B (12/BAG)

3C (12/BAG)



AC Leaf & Debris Protector

This adjustable AC & Leaf Debris Protector, accommodates condensing unit sizes up to 4'x4' and covers all new high Seer residential units. It secures to the unit with heavy-duty elastic bands and makes spring cleaning easy 1/4" x1/4" openings.

ALDP

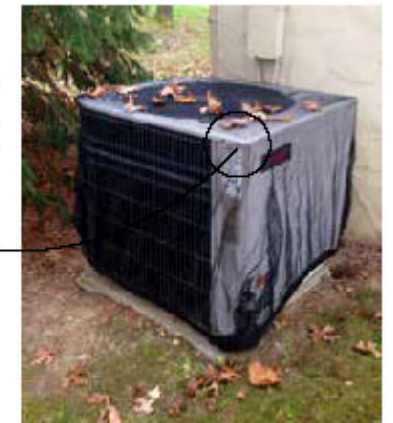
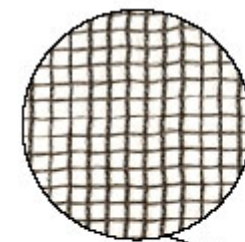

Smoke Check



SmokeCheck™, Smoke Detector Tester puts both photoelectric and ionization smoke detectors through their paces to ensure that the circuitry, alarm and power is functioning and that they are actively sampling the air for any hint of a fire. Our patented formulation simulates the entire range of fire conditions giving you the confidence of knowing your fire alarm system will respond promptly to all fire conditions. This product is approved for testing smoke detector function per NFPA 72 par. 8-2.4.1 when used as directed. Our SmokeCheck™, Smoke Detector Tester does not have HFC or CFC. Our products do not damage the Ozone layer and do not contribute to Global Warming. SmokeCheck™ has always been environmentally friendly. We did not change our products to comply with new codes or protocols. They were originally designed to be environmentally friendly. UL & ULC Listed, NFPA 72 Compliant, Safe on sensors.

SDT-25S

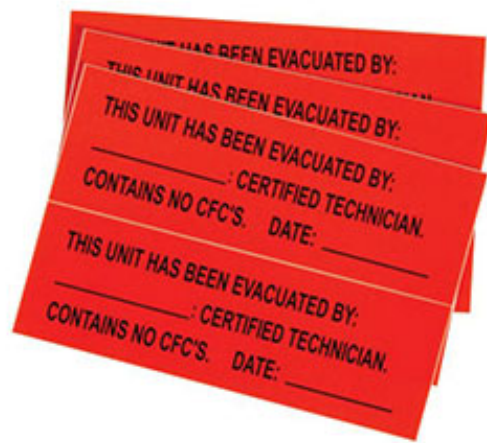

ESP Unit Disposal Labels

6 labels per packet, Bright orange.

UD12

Bulls Eye Nozzle

This carded adjustable hose nozzle, sprays a fine stream up to a solid heavy blast of water. Made of brass and stainless steel bearings.

810-C

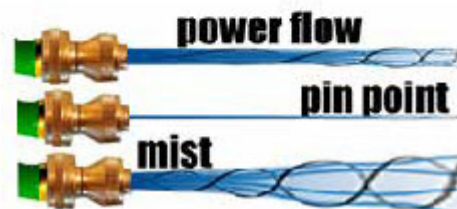

ESP Industrial First Aid Kit

These 10, 25, 50 or 100 person weatherproof kits include all components listed in chart below

Contents:

Description	#10
Adhesive Strips	16
Large Wound Dressing	—
Gauze Pads 4 (3")	—
Gauze Bandage, 4" Eye	1
Pads	2
Adhesive Tape, 1/2"	1
Triangular Bandage	1
Elastic Bandage	—
Antiseptic Towelettes	10
First Aid Cream Packets	—
Aspirin	10
Eye Flush, 1 oz. (1)*	—
Eye Flush, 4 oz.	—
Cold Pack	0
Latex Exam Gloves	2 pr.
Scissors	1
Forceps	1
First Aid Instructions	1



FA6060 (10 person)

Oil Refractometer



This precise instrument is used to determine percentage of mineral oil in a refrigeration system during a POE (polyol ester) changeover. A brix scale, a refractive index, or any list of markings can be used to determine mineral oil percentage. ESP utilizes the brix scale. Copeland recommends a 5% mineral oil level as acceptable. At a 65.9 brix reading (E.S.P. Scale) or below, the residual mineral oil is at that safe level. No need to plot graphs. Easily understandable directions packed with the unit in a foam filled carrying case with oil dropper and calibration screw driver.

RHB-82 for POE unit

RHB-82-ND BVA Oil Refractometer

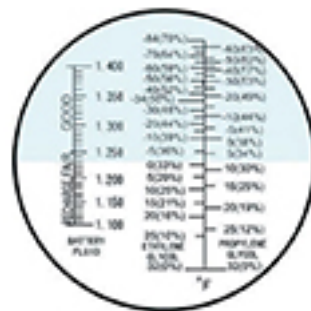

Glycol Refractometer

This instrument will give "good down to" temperatures for both ethylene and propylene glycol solutions, and an exact percentage of glycol calculation on the scale. Operates just like the oil refractometer in that the operator places a drop or two of solution on the Daylight Plate of the instrument, and then as he looks thru the eyepiece and focuses, a separation on the scale shows an accurate reading.

RHB-82G

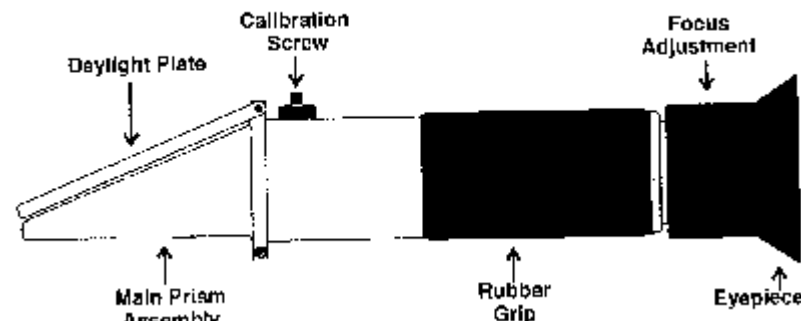

Thermo Plug

The Thermo Plug is a dual socketed temperature activated, single set point thermostat. Great for heat tapes, electric heaters, sump and tower heaters. Available in 35F and 50F.



THERMO PLUG #TP35



- Saves Energy - only operates when necessary.
- Red Power Indicator Light illuminates when power is on.
- Easy setup. The thermostat plugs into any standard outlet. No special wiring required. 120Volt 60Hz, Combined Maximum 15 amp and 1800 Watts.

- For indoor use only in residential or commercial applications.
- Follow the Heater Manufacturer Instructions before connecting the device.
- TP35 Turns a heater or other device on at approximately 35F (4C) and off at 45F when ambient temperature rises. TP50 turns on at 50F and off at 60F

THERMO PLUG #TP35

The Thermo Plug is available in 35 F (on at 35, off at 45)

THERMO PLUG #TP50

The Thermo Plug is available in 35 F (on at 50, off at 60)

Fast Stat

Upgrade your HVAC equipment without new wiring. Receiver and sender included. Run two stage equipment and more over two wire communication.



FSCM00 - Adds a common to a thermostat cable

FS1000 - Adds one wire to a thermostat cable

FS3000 - Adds two wires to a thermostat cable

FS5000 - Adds three wires and a common

FS7000 - Extends the wiring between a heat pump, indoor unit, and thermostat

FS9000 - Extends the wiring between a heat pump and indoor unit



Master Heat Gun

Heavy-duty industrial quality heat gun with temperature and power ratings of 750° F (399°C) and 1680 watts (120V). The airflow rating is 23 CFM at 3,000 FPM. A universal motor, die cast aluminum housing, reinforced mica-insulated ceramic heating element, and externally replaceable carbon brushes make the Master Heat Gun a rugged, reliable source of flameless heat whether you're working with freezer coils, plastic laminates, circuit boards, PVC, fiberglass, or heat-shrinkable materials.

HG501A



ECOHEAT™ Heat Gun

An economical, low cost, entry level, multi-use heat gun. Perfect for industrial and commercial applications.

Features & Benefits:

- Two heat settings 500° and 1000°F, 120V, 10 Amps, 1200 Watts
- Lightweight (1 lb.), easy to hold at any angle for long periods
- Built-in hand guard, protects hands and fingers
- 3-Wire grounded cordset
- UL and CIL listed
- Thermoplastic case, for high impact durability

EC-200



Flame Guardian™

This unique non-asbestos flame-guard system protects wood, painted or metal surfaces from the heat and flame of a torch. This 9-1/2" x 12-1/2" pad with aluminum backing can be formed to any application.

FG12



Reusable Heat Blocker

Reusable heat trap in a can. Completely stops heat down ferrous or non-ferrous pipe. Easily molds to any shape. Removes quickly & cleanly after each application. No drip or mess. Good for 100 jobs. 12 oz. Jar.

HB34



Busmann Limitron

U.L. listed for branch circuit protection, motor control circuits, lighting ballasts, and control transformers. Grooved ferrule permits mounting in rejection type fuseholders as well as standard non-rejection type.

KTK-R (600V) (1-30A)



Busmann Glass and Specialty Fuses

ESP now makes these glass and specialty Buss fuses available to the diversified wholesaler.

ABC 1-30; AGX 1-50; AGC 1/2 - 30; GLQ 3-10; C2 -2-1/2; GMF 1-5; or No. 263-R; MDL 1-30





Bussmann Fusetron

These dual element, time delay fuses afford the same excellent overload protection of low-peak fuses of motors and other type loads having temporary inrush currents such as caused by transformers and solenoids.

FRN-R 250V and FRS-R 600V (2-1/2 - 200 A)

Bussmann low cost FRN-R replacements are also available.

ECNR10-100

Buss Fustat and Fustron Plug-In Fuses

Available in 1-1/4 thru 60 amp sizes.

S & SL (2-30A), SC (1-60A), Part # T & TL (1-1/4-30A)



Buss Fustat and Fustron Plug-In Fuses

Available in 1-1/4 thru 60 amp sizes.

S & SL (2-30A), SC (1-60A), Part # T & TL (1-1/4-30A)

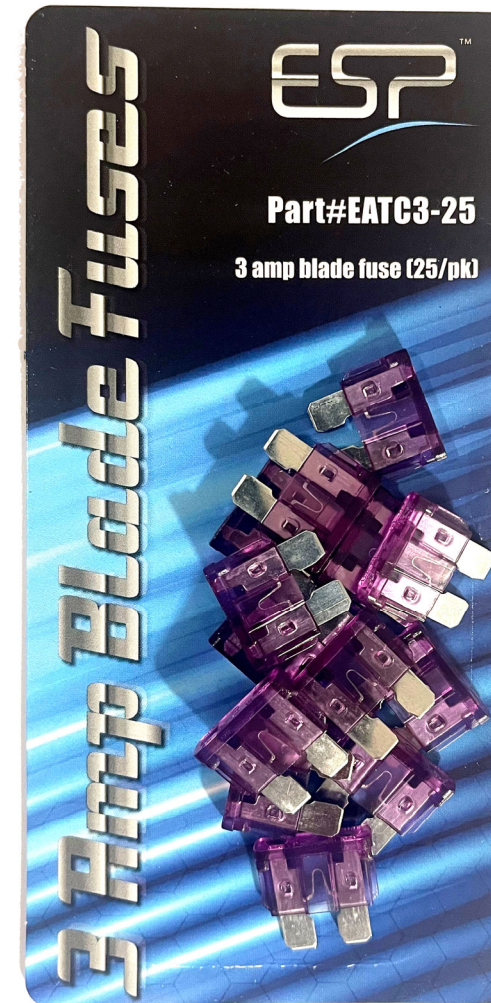

Bulk ATC Fuses

25 pack of blade type fuses. 3 amp and 5 amp available. UL listed

EATC3-25 - 25 pack of ATC3 fuses

EATC5-25 - 25 pack of ATC5 fuses

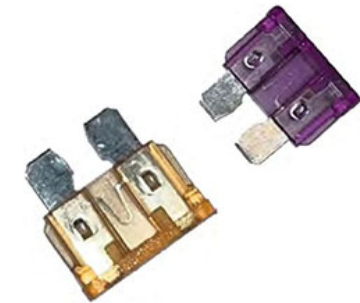

ATM Fuses

Mini type blade fuses used on some residential equipment

ATM3 (5/cs)

ATM5 (5/cs)



ESP Wago Connectors

Be prepared to provide customers with everything they'll need for R290 and beyond. Pull the lever up, insert a conductor and push the lever back down – done! As tool-free, lever-actuated connectors, WAGO's 221 Series Splicing Connectors easily, quickly and safely connect solid, stranded and fine-stranded conductors ranging from 24–10 AWG.



NOTE: Wire nuts are not approved for R290. All connections must be UL approved such as a push and lock connectors for wire connections. These connectors must have sufficient strength to hold the wire in place.



Bulk Connectors in Brown Boxes

Part Number	# of Conductors	Connectors Per Box
221-412	2	100
221-413	3	50
221-415	5	25
221-2401	Butt Splice	60

10 Pack Connectors in Clamshells

Part Number	# of Conductors	Connectors Per Clam
221-412/996-010	2	10
221-413/996-010	3	10
221-415/996-010	5	10
221-2401/K000-0004	Butt Splice	10

Bussmann Fuse Holders

These four Bussmann fuse holders are now available for your HVAC needs.



HPF - 10 /ctn
HPS - 10 /ctn
HRK - 10 /ctn

Bussmann Fuse Pullers

The safest, non-conductive tools used to remove fuse. Always remove power from fuse circuit before removing fuse.



FP-2 for 13/32" to 13/16 dia. fuses
FP-3 for 1" to 1-3/4" dia. fuses

Bussmann fused outlets, switches and receptacles

Also well stocked in our warehouse



SSU (switch)
SSY (fused receptacle)

Bussmann Blade type fuses

For P.C. board applications. Fast acting, 36V, UL recognized 3-40 A



ATC 1 through ATC 40

Transition Terminals

To be used when control connectors don't match wire connections during replacements.

- Transition Terminals from .250 Female to .187 Male, and .187 Female to .250 Male

TT10 – 5 per pack



Tool Light Flashlight

This unique tool light slips onto the shaft of any screwdriver, 3/16"-7/16" lights up the work area with three LED. Just turn the grooved edge clockwise to turn on and off. Three magnets on the back will also hold it to the inside of your toolbox, or inside of a control compartment.

12 Per display box

TLFL



ESP Power Cords



ESP power cords are outdoor heavy capacity electrical cords, 12 or 14 gauge, 25', 50' or 100'.

HC14-25, 50, 100

HC12-25, 50, or 100

ESP Power Block



ESP Power Blocks are heavy duty, 3 outlet electrical cords. Plug three power tools or appliances into one outlet. Available in 12 or 14 gauge, 25', 50', or 100'.

PB14-25, 50, or 100; PB12-25, 50, or 100

ESP offers a premium quality TPE-rubber cord Power Block for extremely high and sub-zero temperatures. Available in 12 gauge with 2' cord.

PD12-2

ESP Light Bulbs



Light bulbs are now available in LED: 60W, 75W, 100W.

RS60

RS75

RS100



ESP Acid Blaster

This is the premium two gallon compression sprayer manufactured specifically with the AC&R contractor in mind. This sturdy unit incorporates a patented acid valve and utilizes viton gaskets which are chemical resistant. There are no metal parts that contact liquid. Unit has stainless pump rod and plate. The nozzle has adjustable spray levels. Order part # AB10. Repair kits include all gaskets and seals, part # 6-1925.

AB10



ESP "Tommy Gun"

Two quart compression sprayer made out of high pressure impact polyethylene. Equipped with adjustable spray nozzle, the Tommy Gun is lightweight and easy to use.

TG007



ESP Big Shot III.

This three gallon, acid resistant sprayer incorporates viton and polypropylene parts to minimize nuisance breakdowns and leakage. The wide angle, high delivery spray head provides quick application time and makes the coil cleaning job an easier one for your contractors.

BS30



Tommy II

48 ounce sprayer in red, poly nozzle.

**TGII
3-1802 (Nozzle)**

Acid Blaster and Big Shot Replacement parts

6-1925 Gasket Kit includes: viton check, diaphragm, O-ring and gasket for handle; 6-7748, AB10 or BS30 Wand; 6-4626, AB10 or BS30 Handle; 6-6003, AB10 or BS30 Nozzle; 6-6136, AB10 or BS30 Hose Assembly.



6-6136, AB10 or BS30 Hose Assembly



6-1925 Gasket Kit



6-7748, AB10 or BS30 Wand



6-6003, AB10 or BS30 Nozzle



6-4626, AB10 or BS30 Handle

ESP "Tommy Gun" Replacement Parts

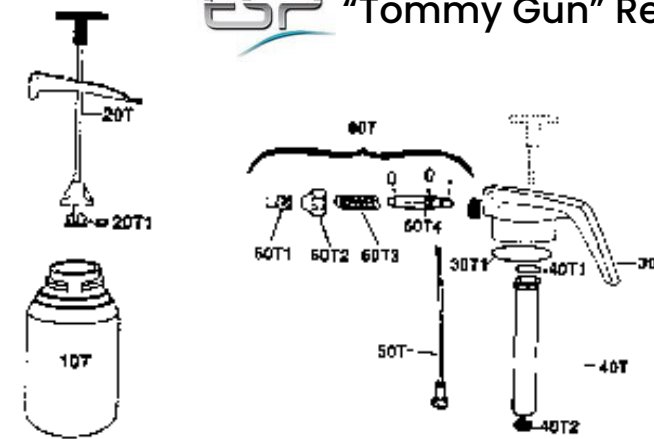

- 10T - Container only
- 20T - Plunger complete
- 20T1 - Plunger O-ring,
- 30T - Pump head only
- 30T1 - Container Sealing O-Ring,
- 40T - Pump barrel
- 40T1 - Sealing O-Ring,
- 40T2 - Non Return Valve
- 50T - Dip Tube & Filter
- 60T - Nozzle & Spindle Assembly,
- 60T4—Nozzle Spindle
- 90T - Complete Set of O-Rings and pump Non Return Valve.



Triple Shot Foamer

Unique foamer tip produces a large volume of clinging foam. Comfort-grip cushioned trigger delivers 3.5 ML per stroke (3-4 times vs. our general purpose units). 32 oz. clear bottle makes product recognition an easy task.

TS32 (12/cs)



Chem-Sprayer

This chemical resistant sprayer holds up against harsh chemicals and solvents that cause standard trigger sprayers to fail. Adjustable nozzle, o-ring, and piston cup are made of chemical resistant viton. 32 oz. clear bottle to ease product recognition.

CR32 (12/cs)



High Delivery Sprayer

High delivery sprayer delivers 3.5 ML per stroke with adjustable nozzle and comfortgrip trigger. 32 oz. clear bottle to ease product recognition.

HD32 (12/cs)

Industrial Sprayer



Economic design with extra long trigger for comfort. Provides average chemical resistance 24 oz. bottle.

IS005 (12/cs)



High Velocity Nozzle

100 psi max. Pistol grip. Heavy Duty

HVNI-25 / Case



Expanding Garden Hose

New and improved ESP black expanding hose expands to 50' when pressure is applied. When removed from pressure, the hose expels all water, avoiding a mess on the truck. Lightweight with heavy duty brass fittings plus shut off valve

BX50-30 / Case



Premium Rubber Garden Hose

- 400+ PSI burst strength
- Premium rubber garden hose that's powerful and strong yet easy to handle
- Ideal for commercial use in all weather conditions
- Exclusive rubber formula makes it 2X stronger and 40% lighter than standard rubber hoses
- Flexible to -40 degrees Fahrenheit
- Patented Hose Armour® prevents kinking at the water source
- Extra-large, crush-proof aluminum couplings can withstand being run over by heavy machinery

Available in 25', 50', 75', and 100' in length

PRGH5825 - 25'

PRGH5850 - 50'

PRGH5875 - 75'

PRGH58100 - 100'

Diamond Vent Screens

These covers and caps prevent pest infestations, bird nests, and other nuisance issues on air intake and exhaust lines. 2", 3", and 4" PVC screens available. Concentric caps for 2" and 3" available



DVS-2

DVS-3

DVS-4

CV-2 DVS

CV-3 DVS



Mini Split Fitting

This is the next generation of AC MC connectors. They are designed to accommodate a broad range of cables. Each trade sized hub range overlaps the adjacent hub range, thereby minimizing the possibility of mismatched cables and fittings in the field

TECK50



Thermostat Guards

Polycarbonate and Steel versions available. Stainless Steel also available upon request. Mounting hardware included. 2 chrome plated keys included. Mount vertical or horizontal.

TP01CL - Polycarbonate mini

TP02CL - Polycarbonate small

TP03CL - Polycarbonate medium

TP04CL - Polycarbonate large

TP06M - Steel medium

TP07M - Steel large

TP08M - Steel mini

HVAC Service Center

Pre-wired switch box comes with an always hot 15 amp GFCI and service switch. 8' whip connects switch box with junction box. 12 awg wire.

HVACSC-1



High Pressure Control Hoses

Captube / Superhose replacement. Great for refrigerant pressure sensing applications. 1000 psi working pressure rated. Approved for most refrigerants and oils. 2mm inside diameter. 1/4" SAE fittings



- HPCH18 - 18" STRAIGHT X 90 DEGREE**
- HPCH24 - 24" STRAIGHT X 90 DEGREE**
- HPCH30 - 30" STRAIGHT X 90 DEGREE**
- HPCH36 - 36" STRAIGHT X 90 DEGREE**
- HPCH48 - 48" STRAIGHT X 90 DEGREE**



Natural Refrigerant Charging Hoses

Perfect for charging critically charged R290 or R600 units. Small diameter means minimal charge loss. 1/4" charging fittings



- SH12KIT - 12" long set of 3 hoses STRAIGHT X 35 DEGREE**
- SH18KIT - 18" long set of 3 hoses STRAIGHT X 35 DEGREE**
- SH12Y - 12" long single hose STRAIGHT X 35 DEGREE**
- SH18Y - 18" long single hose STRAIGHT X 35 DEGREE**

Oil Hoses

For applications that require oil flow as opposed to pressure sensing



- 522-0024-24 - 1/4 SAE STRAIGHT X 90 24" LONG**
- 522-0024-36 - 1/4 SAE STRAIGHT X 90 36" LONG**
- 533-0024-24 - 3/8 SAE STRAIGHT X 90 24" LONG**
- 533-0024-36 - 3/8 SAE STRAIGHT X 90 36" LONG**



ESP High Pressure Control Hose and Assembly Kit

High Pressure Control Hose and Assembly Kit

ESP offers pre-terminated high pressure control hoses to customers who want to avoid systems issues frequently caused by vibration on their pressure control connections. Standard hoses are straight flare nut x 90 degree flare nut. Other lengths and fitting configurations available by request. UV resistant jacket. 1000 psi working, 5000 psi burst. POE, alkylbenzene, and mineral oils acceptable.



HPCH 18", 24", 36", 48", and 60" (Hose Length)

High Pressure Control Hose Kit

This handy control hose kit includes 24' of 2MM hose, with cutter, crimper, and a wide assortment of over fifty straight, and 90 degree fittings. Also has core depressors, copper gaskets, everything a professional technician needs to make his own custom length hoses on site. No more wasted trips to the supply house. Essential to the upper echelon of contractors.

HPHK



2006-34



2007-41



2007-33



2006-38



2007-44



2026-14



2007-31



2001-26



2007-07



HPCH Control Hoses



HPHK Kit

**SCHAEFER
BRUSH**

**Premium Refrigeration Fitting Brushes
900 Series Stainless Steel Wire**

The highest quality fitting brush, double spiral 4-ply wire construction. Solid plastic hand fitting handle with convenient hole for hanging. Individual package.



OD REFRIGERATION SIZES				OD REFRIGERATION SIZES			
PART #	SIZE	PACK	WGT	PART #	SIZE	PACK	WGT
00924-1	1/4"	1	.04	00931-1	1-1/8"	1	.08
00925-1	3/8"	1	.08	00932-1	1-3/8"	1	.08
00926-1	1/2"	1	.08	00933-1	1-1/2"	1	.08
00927-1	5/8"	1	.08	00934-1	1-5/8"	1	.08
00928-1	3/4"	1	.08	00935-1	2-1/8"	1	.08
00929-1	7/8"	1	.08	00936-1	2-3/8"	1	.10
00930-1	1"	1	.08	00937-1	2-5/8"	1	.10

**Premium Plumbing Fitting Brushes
900 Series Stainless Steel Wire**

The highest quality fitting brush, double spiral 4-ply wire construction. Solid plastic hand fitting handle with convenient hole for hanging. Individual package.



OD REFRIGERATION SIZES				OD REFRIGERATION SIZES			
PART #	SIZE	PACK	WGT	PART #	SIZE	PACK	WGT
00943-1	1/8"	1	.04	00949-1	1"	1	.10
00944-1	1/4"	1	.08	00950-1	1-1/4"	1	.10
00945-1	3/8"	1	.08	00951-1	1-1/2"	1	.12
00946-1	1/2"	1	.10	00952-1	2"	1	.12
00947-1	5/8"	1	.10	00953-1	2-1/4"	1	.14
00948-1	3/4"	1	.110	00954-1	2-1/2"	1	.14

FITTING BRUSH SIZES & ACTUAL BRUSH DIAMETERS					
Fitting brushes are referred to by the size fitting they are designed to clean					
PLUMBING ID BRUSH AND FITTING SIZE	REFRIGERATION OD BRUSH AND FITTING SIZE	ACTUAL BRUSH DIAMETER	PLUMBING ID BRUSH AND FITTING SIZE	REFRIGERATION OD BRUSH AND FITTING SIZE	ACTUAL BRUSH DIAMETER
1/8"	1/4"	9/32"	1"	1-1/8"	1-3/16"
1/4"	3/8"	7/16"	1-1/4"	1-3/8"	1-7/16"
3/8"	1/2"	9/16"	1-1/2"	1-5/8"	1-3/4"
1/2"	5/8"	11/16"	2"	2-1/8"	2-1/4"
5/8"	3/4"	13/16"	2-1/4"	2-3/8"	2-1/2"
3/4"	7/8"	15/16"	2-1/2"	2-5/8"	2-3/4"

SCHAEFER BRUSH

2-IN-1 TOOL

A combination tool that fits your hand comfortably and really works. One end cleans the fitting; the other cleans the tub.



PART #	PLBG. ID SIZE	REFRIG. OD SIZE	PACK	WEIGHT
00996-12	1/2"	5/8"	12	1.44
00998-12	3/4"	7/8"	12	1.44
00996-100	1/2"	5/8"	100	12
00998-100	3/4"	7/8"	100	12

Outside Tube Cleaning Brush

Tough molded plastic holder with comfortable sure grip design and high carbon steel bristles. Packed 6 per box.



PART #	PLBG. ID SIZE	REFRIG. OD SIZE	PACK	WGT	PART #	PLBG. ID SIZE	REFRIG. OD SIZE	PACK	WGT
00963-6	1/8"	1/4"	6	.24	00967-6	3/4"	5/8"	6	.48
00964-6	1/4"	3/8"	6	.24	00968-6	7/8"	7/8"	6	.48
00965-6	3/8"	1/2"	6	.24	00969-6	1"	5/8"	6	.48
00966-6	1/2"	5/8"	6	.24	00970-6	1-1/8"	7/8"	6	.48

Nylon Tube Brush



PART #	DIA. X BRUSH PART	OAL	PACK	WGT	PART #	DIA. X BRUSH PART	OAL	PACK	WGT
14504	1/4" x 2"	6-1/2"	12	.7	14529	3/4" x 3"	9"	12	1.1
14506	1/4" x 2"	15"	12	.7	14530	3/4" x 3"	15"	12	1.3
14509	5/16" x 2"	15"	12	.8	14533	3/4" x 3"	30"	12	3.0
14510	3/8" x 2"	6-1/2"	12	.7	14539	1" x 4"	15"	12	1.5
14512	3/8" x 2"	15"	12	1.1	14547	1-1/4" x 4"	15"	12	1.5
14515	7/16" x 2"	15"	12	1.1	14565	1-1/2" x 4"	15"	12	1.8
14517	1/2" x 3"	9"	12	.9	14567	1-1/2" x 4"	36"	12	3.5
14518	1/2" x 3"	15"	12	1.1	14573	1-3/4" x 4"	15"	12	1.8
14520	1/2" x 3"	30"	12	3.0	14582	2" x 4"	15"	12	2.0
14524	5/8" x 3"	15"	12	1.1	14588	2-1/4" x 4"	36"	12	3.5

Natural Bristle or Hair



PART #	DIA. X BRUSH PART	OAL	PACK	WGT	PART #	DIA. X BRUSH PART	OAL	PACK	WGT
10209	1/4" x 2"	6-1/2"	12	.8	10212	3/4" x 3"	9"	12	1.1
10210	3/8" x 2"	6-1/2"	12	.8	10214	3/4" x 3"	12"	12	1.2
10220	3/8" x 2"	9"	12	.9	10213	1" x 4"	12"	12	1.3
10211	1/2" x 3"	9"	12	.8	10216	1" x 4"	18"	12	1.8
10221	1/2" x 3"	12"	12	1.1	10217	1-1/4" x 4"	18"	12	1.9
10222	1/2" x 3"	18"	12	1.2	10218	1-1/2" x 4"	18"	12	2.0
10223	1/2" x 3"	24"	12	1.3	10225	1-3/4" x 4"	18"	12	2.1
10224	1/2" x 3"	36"	12	2.3	10226	2" x 4"	18"	12	2.3

SCHAEFER BRUSH

LONG HANDLE STAINLESS STEEL SINGLE SPIRAL TUBE BRUSHES - 144 SERIES

3' brush part with long handle, filled with medium stiff wire.



PART #	EXACT DIA.	OAL	PACK	WGT	PART #	EXACT DIA.	OAL	PACK	WGT
14402	1/4"	15"	1	.04	14442	1/4"	27"	1	.08
14404	3/8"	15"	1	.06	14444	3/8"	27"	1	.10
14406	1/2"	15"	1	.08	14446	1/2"	27"	1	.14
14408	5/8"	15"	1	.10	14448	5/8"	27"	1	.18
14410	3/4"	15"	1	.12	14450	3/4"	27"	1	.18
14412	7/8"	15"	1	.12	14452	7/8"	27"	1	.19
14414	1"	15"	1	.12	14454	1"	27"	1	.19
14416	1-1/4"	15"	1	.12	14456	1-1/4"	27"	1	.19
14418	1-1/2"	15"	1	.13	14458	1-1/2"	27"	1	.20

LARGE DIAMETER BRASS TUBE BRUSHES

Double stem with 1/4" male pipe thread.



PART #	BRUSH DIA.	BRUSH LGTH	PACK	WGT	PART #	BRUSH DIA.	BRUSH LGTH	PACK	WGT
43636	1-1/4"	4-1/2"	1	.30	43653	2-3/4"	4-1/2"	1	.42
43639	1-1/2"	4-1/2"	1	.32	43656	3"	4-1/2"	1	.44
43642	1-3/4"	4-1/2"	1	.32	43658	3-1/4"	4-1/2"	1	.44
43645	2"	4-1/2"	1	.32	43660	3-1/2"	4-1/2"	1	.54
43648	2-1/4"	4-1/2"	1	.36	43662	3-3/4"	4-1/2"	1	.56
43651	2-1/2"	4-1/2"	1	.40	43664	4"	4-1/2"	1	.56

NYLON LARGE DIAMETER TUBE BRUSHES

Single stem with 1/4" male pipe thread.



PART #	BRUSH DIA.	BRUSH LGTH	PACK	WGT	PART #	BRUSH DIA.	BRUSH LGTH	PACK	WGT
43736	1-1/4"	5"	1	.18	43753	2-3/4"	5"	1	.32
43739	1-1/2"	5"	1	.24	43756	3"	5"	1	.32
43742	1-3/4"	5"	1	.24	43758	3-1/4"	5"	1	.34
43745	2"	5"	1	.26	43760	3-1/2"	5"	1	.38
43748	2-1/4"	5"	1	.26	43762	3-3/4"	5"	1	.44
43751	2-1/2"	5"	1	.32	43764	4"	5"	1	.44



REFRIGERATOR COIL DUSTING & CLEANING BRUSHES

Used to clean refrigerator coils, fan blades and areas under and behind appliances.



PART #	MATERIAL	STEM DIA.	DESCRIPTION	PK.	WT.
00405	Bristle	.200	3/4" & 1-1/2" x 12" BR. 15" Wood HDL 28" O.A.L.	36	8.2
00415	Bristle	.200	Same as 00405 in single box	1	.44
50405	Bristle	.200	Same as 00405 on 4-color card	10	3.3
00406	W. Poly	.225	3/4" & 1-1/2" x 12" BR. 4-1/2" Wood HDL 28" O.A.L.	36	9.8
00416	W. Poly	.225	Same as 00406 in single box	1	.48
00408	Bristle	.200	3/4" to 1-1/2" taper x 12" BR. 4-1/2" Wood HDL 27" O.A.L.	36	9.2
00402	Bristle	.200	2" x 6" BR. x 24" O.A.L.	36	8.2
00403	Bk. Poly	.225	3/4" to 1-1/2" taper x 12" BR. 2-1/4" x 7" Br. x 24" O.A.L.	36	9.2

DUCT CLEANING BRUSH

7" long brush part with twisted wire stem and plastic, or wood handle.



PART #	MATERIAL	BRUSH DIA.	OVERALL LENGTH	PACK	WGT
76200	Cr. Brass Wire	2-1/8"	48"	1	.44
76210	Stainless Steel	2-1/8"	48"	1	.50
76220	Black Pat. Fibre	2-1/8"	48"	1	.40

FIBRE/HAIR MIX FURNACE & BOILER BRUSHES
7624 SERIES

Extra heavy fill, 6" long brush part with twisted wire handle and large loop end.



PART #	BRUSH DIA.	OVERALL LENGTH	PACK	WGT
76243	3"	27"	1	.34
76245	2"	42"	1	.44

RADIATOR OR REFRIGERATOR BRUSHES

Black natural bristle, twisted in wire with loop end.



PART #	STEM DIA.	BRUSH DIA.	OVERALL LENGTH	BRUSH LENGTH	PACK	WGT
00450	.200	1/2" to 1"	36"	7"	12	3.36
00442	.225	1" to 2"	42"	7"	12	4.56



RADIATOR DUSTING & CLEANING BRUSH

Twisted in wire with plastic handle at end.



PART #	MATERIAL	BRUSH LENGTH	BRUSH DIA.	OVERALL LENGTH	PACK	WEIGHT
76221	Bristle or Hair	7"	2"	27"	1	.22
76324	Black Horsehair	7"	2-1/2"	27"	1	.22
76524	HH/Poly Mix	7"	2-1/2"	27"	1	.22

LONG WOOD HANDLE DUSTING BRUSH W/FLARED TIP

One row, curved lacquered wood handle



PART #	MATERIAL	BRUSH LENGTH	BRUSH TRIM	OVERALL LENGTH	PACK	WEIGHT
76026	Horsehair	10"	2-1/4"	24"	1	.26

NYLON SINGLE SPIRAL
CONDENSER TUBE BRUSHES - 437 & 937 SERIES

Single spiral/single stem construction recommended for cleaning all tubes where deposits are light. 1/4" and 5/16" dia. brushes with female couplings have 8-32 threads, while 3/8" thru 1" dia. have 12-24 threads. 1/4", 5/16", and 3/8" dia. brushes with male couplings have 8-32 threads, while 7/16" thru 1" dia. have 1/4-28 threads.



BRUSH DIA.	BRUSH LENGTH	FEMALE THREAD	FEMALE PART	MALE THREAD	MALE PART	PACK	WEIGHT
1/4"	3"	8-32	43702	8-32	93702	1	.04
5/16"	3"	8-32	43703	8-32	93703	1	.04
3/8"	4"	12-24	43704	8-32	93704	1	.08
7/16"	4"	12-24	43707	1/4-28	93707	1	.10
1/2"	4"	12-24	43710	1/4-28	93710	1	.10
9/16"	4"	12-24	43713	1/4-28	93713	1	.10
5/8"	4"	12-24	43716	1/4-28	93716	1	.10
11/16"	4"	12-24	43719	1/4-28	93719	1	.10
3/4"	4"	12-24	43722	1/4-28	93722	1	.10
13/16"	4"	12-24	43725	1/4-28	93725	1	.10
7/8"	4"	12-24	43728	1/4-28	93728	1	.10
15/16"	4"	12-24	43731	1/4-28	93731	1	.10
1"	4"	12-24	43733	1/4-28	93733	1	.10



SCHAEFER
BRUSH

**BRASS SINGLE SPIRAL CONDENSER
TUBE BRUSHES- 436 & 936 SERIES**

Single spiral/double stem construction recommended for brass or copper tubes. 1/4" and 5/16" dia. brushes with female couplings have 8-32 threads, while 3/8" thru 1" dia. have 12-24 threads. 1/4", 5/16", and 3/8" dia. brushes with male couplings have 8-32 threads, while 7/16" thru 1" dia. have 1/4-28 threads.



BRUSH DIA.	BRUSH LENGTH	FEMALE THREAD	FEMALE PART	MALE THREAD	MALE PART	PACK	WEIGHT
1/4"	3"	8-32	43602	8-32	93602	1	.06
5/16"	3"	8-32	43603	8-32	93603	1	.06
3/8"	4"	12-24	43604	8-32	93604	1	.10
7/16"	4"	12-24	43607	1/4-28	93607	1	.10
1/2"	4"	12-24	43610	1/4-28	93610	1	.10
9/16"	4"	12-24	43613	1/4-28	93613	1	.14
5/8"	4"	12-24	43616	1/4-28	93616	1	.14
11/16"	4"	12-24	43619	1/4-28	93619	1	.14
3/4"	4"	12-24	43622	1/4-28	93622	1	.14
13/16"	4"	12-24	43625	1/4-28	93625	1	.16
7/8"	4"	12-24	43628	1/4-28	93628	1	.16
15/16"	4"	12-24	43631	1/4-28	93631	1	.16
1"	4"	12-24	43633	1/4-28	93633	1	.16

STAINLESS STEEL SINGLE SPIRAL - 435 & 935 SERIES

Single spiral/double stem construction recommended for stainless steel tubes. 1/4" and 5/16" dia. brushes with female couplings have 8-32 threads, while 3/8" thru 1" dia. have 12-24 threads. 1/4", 5/16", and 3/8" dia. brushes with male couplings have 8-32 threads, while 7/16" thru 1" dia. have 1/4-28 threads.



BRUSH DIA.	BRUSH LENGTH	FEMALE THREAD	FEMALE PART	MALE THREAD	MALE PART	PACK	WEIGHT
1/4"	3"	8-32	43502	8-32	93502	1	.02
5/16"	3"	8-32	43503	8-32	93503	1	.06
3/8"	4"	12-24	43504	8-32	93504	1	.10
7/16"	4"	12-24	43507	1/4-28	93507	1	.10
1/2"	4"	12-24	43510	1/4-28	93510	1	.10
9/16"	4"	12-24	43513	1/4-28	93513	1	.10
5/8"	4"	12-24	43516	1/4-28	93516	1	.14
11/16"	4"	12-24	43519	1/4-28	93519	1	.14
3/4"	4"	12-24	43522	1/4-28	93522	1	.14
13/16"	4"	12-24	43525	1/4-28	93525	1	.14
7/8"	4"	12-24	43528	1/4-28	93528	1	.14
15/16"	4"	12-24	43531	1/4-28	93531	1	.16
1"	4"	12-24	43533	1/4-28	93533	1	.16

SCHAEFER
BRUSH

TIN HANDLE ACID & DOPE BRUSHES

Selected horsehair bristles are pressed securely in tin handles. Sold in gross packs only.



PART #	BRUSH WIDTH	HANDLE LENGTH	PACK	WEIGHT
10001	3/8"	5"	144	2.14
10002	1/2"	5"	144	2.64
10003	5/8"	5"	144	3.30

WOOD HANDLE DOPE BRUSH

Selected horsehair bristles secured tightly in metal ferrule. Sold in packs of 36.



PART #	BRUSH WIDTH	OVERALL LENGTH	BRUSH MATERIAL	PACK	WEIGHT
10007	3/4"	7"	Horsehair	36	1.34

IMPORT WHITE BRISTLE CHIP BRUSHES

White Chinese bristle, metal ferrule. Plain sanded wood handle. Low priced economy import.



PART #	WIDTH	THICKNESS	TRIM	PACK	WEIGHT
67191	1/2"	1/4"	1-3/8"	36	.72
67192	1"	5/16"	1-5/8"	36	1.44
67193	1-1/2"	5/16"	1-5/8"	36	1.44
67194	2"	5/16"	1-5/8"	24	1.44
67195	2-1/2"	3/8"	1-5/8"	24	2.40
67196	3"	3/8"	1-5/8"	24	2.40
67197	4"	11/16"	1-5/8"	12	3.84

IMPORT BLACK BRISTLE CHIP

Black Chinese bristle in a chemical resistant plastic handle.



PART #	WIDTH	THICKNESS	TRIM	PACK	WEIGHT
67230	1/2"	1/4"	1-3/8"	1	.02
67231	1"	5/16"	1-5/8"	1	.04
67232	1-1/2"	5/16"	1-5/8"	1	.06
67233	2"	5/16"	1-5/8"	1	.06
67234	2-1/2"	3/8"	1-5/8"	1	.10
67235	3"	3/8"	1-5/8"	1	.10



WIRE HANDLE CHIP BRUSHES

Ideal for cleaning rust, corrosion, etc. in high heat situations.



PART #	FILL	TRIM	OVERALL LENGTH	PACK	WEIGHT
81616	C. Steel	1-1/2"	5-1/2"	1	.10
81617	St. Steel	1-1/2"	5-1/2"	1	.10

FLAT OIL/CHIP BRUSH

Absorbent natural tampico or poly in a twisted wire handle with ring end. Overall length 8-1/4".



PART #	BRUSH MATERIAL	BRUSH WIDTH	BRUSH LENGTH	PACK	WEIGHT
24800	Tampico	2-1/4"	3"	1	.08
67118	Poly	2-1/4"	3"	1	.06

CONDENSER FIN WHISK, DUSTERS & UPRIGHT BROOMS

Plastic handle whisk for cleaning condenser fins and evaporators - A whisk with a hundred uses.



PART #	BRUSH WIDTH	TRIM	OVERALL LENGTH	PACK	WEIGHT
02026	3-1/8"	2-1/8"	7"	1	.04

Fin and Plenum Brush

The fin and plenum brush - has a 14", extra long handle. The total length of the brush is 18". Bristles are 2" wide, all natural. It's perfect for cleaning coils, and is especially useful for applying mastic and other sealants in hard to reach places.



RAD2 - 12/CS

BENCH DUSTER

Tough and durable brush available in tampico and horsehair.



PART #	MATERIAL	BRUSH FACE	OVERALL LENGTH	TRIM	PACK	WEIGHT
62034	Tampico	2" x 8"	14"	2-5/8"	1	.66



POLYESTER VARNISH BRUSH

Durable black polyester filament with a solvent resistant plastic handle.



PART #	WIDTH	THICKNESS	TRIM	PACK	WEIGHT
67240	1/2"	1/4"	1-5/8"	1	.02
67241	1"	5/16"	1-3/4"	1	.04
67242	1-1/2"	5/16"	1-3/4"	1	.06
67243	2"	5/16"	1-3/4"	1	.08
67244	2-1/2"	3/8"	2"	1	.10
67245	3"	3/8"	2"	1	.12

PARTS CLEANING BRUSH

Tampico or Poly fill in strong plastic handles, comes in standard or flow thru style.



PART #	BRUSH MATERIAL	OVERALL LENGTH	PACK	WEIGHT
25010	Poly	11-5/8"	1	.17
*25095	Poly	9"	1	.17
25013	Tampico	11-5/8"	1	.17
25015	All Poly	10-3/4"	1	.14

*25095 is a Flow-Thru model.

SHOE HANDLE WIRE HAND BRUSH

10" hardwood handle filled with tempered steel, stainless steel, bronze, brass, fibre or poly.



PART #	FILL	ROWS	FILL SIZE	BRUSH PART	PACK	WEIGHT
81232	T Steel	2 x 17	.012	5"	1	.20
81233	T Steel	3 x 17	.012	5"	1	.28
81234	T Steel	4 x 17	.012	5"	1	.38

SCHAEFER
BRUSH

CURVED HANDLE WIRE HAND BRUSHES

14" hardwood handle filled with tempered steel, stainless steel, bronze, brass, fibre or poly.



PART #	FILL	ROWS	FILL SIZE	BRUSH PART	PACK	WEIGHT
*65341	Brass	4 x 17	.003	3-1/4"	1	.19
55104	Tampico	4 x 19	n/a	6-1/2"	1	.32
55105	Poly	4 x 19	.020	6-1/2"	1	.14
81008	T Steel	2 x 18	.012	6-1/2"	1	.22
81009	T Steel	3 x 19	.012	6-1/2"	1	.32
81010	T Steel	4 x 18	.012	6-1/2"	1	.42
81018	St. Steel	3 x 19	.012	6"	1	.22
81020	St. Steel	4 x 18	.012	6"	1	.38
81025	Bronze	4 x 18	.014	6"	1	.46
81044	Brass	3 x 19	.006	6"	1	.34
81045	Brass	4 x 19	.006	6"	1	.46

*65341 has a straight, 8-3/4" long handle with a 3-1/4" brush part and 3/4" trim

STOVE & APPLIANCE BRUSH

2 X 9 rows, 5/8" trim. 8-5/8" long hardwood block with 2-7/8" long brush part.



PART #	FILL	ROWS	TRIM	OVERALL LENGTH	PACK	WEIGHT
25301	St. Steel	2 x 9	5/8"	8-5/8"	1	.08
25302	Brass	2 x 9	5/8"	8-5/8"	1	.08

DIE CAST BRUSHES

3 X 7 rows, 1/2" trim. 7" long plastic block with 1-1/2" long brush part.



PART #	FILL	ROWS	TRIM	OVERALL LENGTH	PACK	WEIGHT
25404	St. Steel	3 x 7	1/2"	7"	1	.04
25405	Brass	3 x 7	1/2"	7"	1	.04
25406	Bronze	3 x 7	1/2"	7"	1	.04
25407	Nylon	3 x 7	1/2"	7"	1	.04

SCHAEFER
BRUSH

WELDER'S WIRE HAND BRUSH

3 X 7 rows, 1/2" trim. 8" long hardwood block with 1-1/2" long brush part.



PART #	FILL	ROWS	TRIM	OVERALL LENGTH	PACK	WEIGHT
81002	St. Steel	3 x 7	1/2"	8"	1	.04
81003	Brass	3 x 7	1/2"	8"	1	.04
81005	Nylon	3 x 7	1/2"	8"	1	.04
81006	Horsehair	3 x 7	1/2"	8"	1	.04

BRASS WIRE UTILITY BRUSHES

Curved hardwood block with crimped brass wire.



PART #	FILL	ROWS	TRIM	BRUSH PART	PACK	WEIGHT
27698	Brass	6 x 9	5/8"	1-1/4" x 2-1/4"	1	.18
27668	Brass	9 x 10	5/8"	2-1/4" x 3"	1	.36

PROFESSIONAL CHIMNEY BRUSHES

All our professional chimney brushes have extra heavy 1/2" dia. stems, constructed with four lengths of .162 dia. galvanized steel wire. Plated shaft with 3/8" male pipe threads are secured to the stems for easy coupling to our heaviest fiberglass rods.



MASTER CLEAN

Fully filled with round tempered steel wire using double spiral construction. These premium brushes have been the choice of many professional chimney sweeps for years.

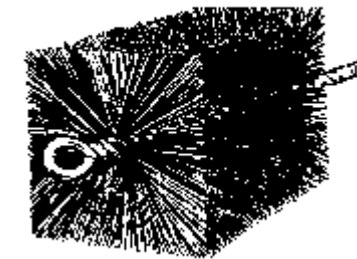

ROUND				SQUARE			
PART #	SIZE	PACK	WEIGHT	PART #	SIZE	PACK	WEIGHT
33066	6"	1	1.90	33277	7"	1	2.10
33076	7"	1	2.00	33288	8"	1	2.10
33086	8"	1	2.10	33299	9"	1	2.60
33096	9"	1	2.50	33310	10"	1	2.80
33106	10"	1	2.60	33311	11"	1	2.90
33116	11"	1	2.70	33312	12"	1	3.10
33126	12"	1	2.80	33314	14"	1	3.40
33266	6"	1	2.00				



FLUE, DUCT, CHIMNEY RODS & T-HANDLES



PART #	PIPE THREAD	PACK	WEIGHT
30599	1/4"	1	.22
30600	3/8"	1	.24

FLUE BRUSH HANDLE

Semi-flexible, twisted galvanized wire with one female end and 1" ring at other end.



PART #	HANDLE LENGTH	PACK	WEIGHT
30328	3"	1	.56
30438	4"	1	.70
30548	5"	1	.86
30658	6"	1	1.06

FIBERGLASS RODS

Strong extruded fiberglass rods in a variety of diameters provide the proper stiffness for most jobs. We recommend using these nonconducting fiberglass rods whenever possible.

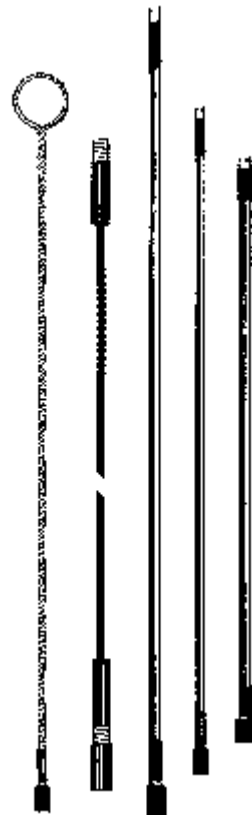

PART #	DIA.	LENGTH	PIPE THREAD	PACK	WEIGHT
30664	.350	4'	1/4"	1	.42
30666	.350	6'	1/4"	1	.68
36048	.440	4'	3/8"	1	.66
36072	.440	6'	3/8"	1	.92
30660	.480	6'	3/8"	1	1.24

EXTENSION HANDLES

Semi-flexible, twisted galvanized wire with female one end and male other.

PART #	HANDLE LENGTH	PACK	WEIGHT
31438	4'	1	.78
31448	5'	1	.92
31458	6'	1	1.04



TEMPERED WIRE SINGLE SPIRAL FLUE BRUSHES

4-1/2" long tempered wire brush part, 1/4" male pipe thread.



PART #	FLUE SIZE	BRUSH DIA.	PK.	WT.	PART #	FLUE SIZE	BRUSH DIA.	PK.	WT.
43206	1"	3/4"	1	.28	43224	2-3/4"	2-1/2"	1	.42
43208	1-1/4"	1"	1	.30	43226	3"	2-3/4"	1	.44
43212	1-1/2"	1-1/4"	1	.32	43228	3-1/4"	3"	1	.46
43214	1-3/4"	1-1/2"	1	.34	43232	3-1/2"	3-1/4"	1	.48
43216	2"	1-3/4"	1	.36	43234	3-3/4"	3-1/2"	1	.50
43218	2-1/4"	2"	1	.38	43236	4"	3-3/4"	1	.52
43222	2-1/2"	2-1/4"	1	.40	43238	4-1/4"	4"	1	.54

TEMPERED WIRE - DOUBLE SPIRAL

4-1/2" long tempered wire brush part, 1/4" male pipe thread. Brushes are individually boxed.



PART #	FLUE SIZE	BRUSH DIA.	PK.	WT.	PART #	FLUE SIZE	BRUSH DIA.	PK.	WT.
43306	1"	3/4"	1	.30	43324	2-3/4"	2-1/2"	1	.44
43308	1-1/4"	1"	1	.32	43326	3"	2-3/4"	1	.46
43312	1-1/2"	1-1/4"	1	.34	43328	3-1/4"	3"	1	.48
43314	1-3/4"	1-1/2"	1	.36	43332	3-1/2"	3-1/4"	1	.50
43316	2"	1-3/4"	1	.38	43334	3-3/4"	3-1/2"	1	.52
43318	2-1/4"	2"	1	.40	43336	4"	3-3/4"	1	.54
43322	2-1/2"	2-1/4"	1	.42	43338	4-1/4"	4"	1	.56

STAINLESS STEEL - SINGLE SPIRAL FLUE BRUSHES

4-1/2" long brush part, 1/4" male pipe thread. Brushes are individually boxed.



PART #	FLUE SIZE	BRUSH DIA.	PK.	WT.	PART #	FLUE SIZE	BRUSH DIA.	PK.	WT.
43536	1-1/2"	1-1/4"	1	.36	43559	3-1/2"	3-1/4"	1	.52
43539	1-3/4"	1-1/2"	1	.38	43562	3-3/4"	3-1/2"	1	.54
43542	2"	1-3/4"	1	.40	43565	4"	3-3/4"	1	.56
43545	2-1/4"	2"	1	.42	43568	4-1/4"	4"	1	.58
43548	2-1/2"	2-1/4"	1	.44	43571	4-1/2"	4-1/4"	1	.60
43551	2-3/4"	2-1/2"	1	.46	43573	4-3/4"	4-1/2"	1	.62
43553	3"	2-3/4"	1	.48	43576	5"	4-3/4"	1	.64
43556	3-1/4"	3"	1	.50	43579	5-1/4"	5"	1	.66

**SCHAEFER
BRUSH**

FLAT BAFFLE BOILER BRUSH

Double spiral, black oil tempered wire brush part with 1/4" male pipe thread. Brushes are individually boxed.



PART #	BRUSH SIZE	BRUSH LENGTH	PK.	WT.
41218	1"	4-1/2"	1	.16
41228	2"	4-1/2"	1	.30
41238	3"	4-1/2"	1	.38
41248	4"	4-1/2"	1	.44

ORIGINAL COLUMBIA BOILER BRUSH

Bristles stick out in all directions and are rough cut to a rectangular shape, approximately 1/2" x 1". Much lighter fill than the flat style.



PART #	BRUSH SIZE	HANDLE LENGTH	PACK	WEIGHT
46328	1/2" x 1" x 4"	3'	1	.36
46348	1/2" x 1" x 4"	4'	1	.46

FLAT STYLE COLUMBIA BOILER BRUSH

Bristles stick out to the 1" dimension as round brush is flattened after being made



PART #	BRUSH SIZE	OVERALL LENGTH	PACK	WEIGHT
46302	1/2" x 1" x 4-1/2"	27"	1	.41
46304	1/2" x 1" x 4-1/2"	48"	1	.72

WEILER MCLAIN BOILER BRUSH

1-1/2" x 1-1/8" x 4" oval shaped brush with crimped carbon steel or soft bristle. Long twisted wire handles with 1" ring end.



PART #	MATERIAL	HANDLE DIA.	O.A.L.	PK.	WT.
14465	Crimped Wire	.20	30"	1	.32
14466*	Crimped Wire	.25	30"	1	.34
14467	Bristle	.20	30"	1	.40
14468*	Crimped Wire	.25	46"	1	.46
14476	Crimped Wire	.135	30"	1	.12
14477	Bristle	.135	30"	1	.10

EXTRA LONG HANDLE/STIFF WIRE BRUSHES- 7625 SERIES

Single spiral fine wire brush part 4" long, twisted in wire handle with loop end. 42" overall length.



PART #	BRUSH SIZE	OVERALL LENGTH	PACK	WEIGHT
76252	1/2"	42"	1	.26
76253	3/4"	42"	1	.28
76254	1"	42"	1	.44
76255	1-1/2"	42"	1	.46
76256	2"	42"	1	.50
76257	2-1/2"	42"	1	.52
76258	3"	42"	1	.54

**SCHAEFER
BRUSH**

SPIN-GRITTM™

Single stem construction with silicone carbide impregnated nylon recommended for brass tubes. This brush is made oversized so the filament will lay over, resulting in increased contact with surface, providing better cleaning and longer life than conventional condenser cleaning brushes.



BRUSH DIA.	TUBE SIZE	FEMALE THREAD	FEMALE PART #	MALE THREAD	MALE PART #	PK.	WT.
1/2"	1/4" - 5/16"	8-32	43482	8-32	93482	1	.02
3/4"	3/8" - 9/16"	12-24	43484	1/4-28	93484	1	.06
1"	5/8" - 11/16"	12-24	43486	1/4-28	93486	1	.06
1 1/4"	3/4" - 1"	12-24	43488	1/4-28	93488	1	.07

SPIN-CLEAN™

Single stem construction with silicone carbide impregnated nylon. This brush is made with a tapered trim to allow better cleaning of enhanced condenser tubes. The long bristles are designed oversized with the intention of bending over, allowing the aggressive filament to come into maximum contact with the lands. The short bristles are able to get into the grooves. These brushes provide better cleaning and longer life than conventional condenser cleaning brushes.



PART #	TUBE SIZE	SMALL DIA. OF BRUSH	LARGE DIA. OF BRUSH
93490	5/8"	5/8"	1"
93491	1/2"	1/2"	3/4"
93492	3/4"	3/4"	1-1/8"

RODS & ROD HANDLES



#13000 - "T" handgrip handle with 1/4-28 cap nut. 4" long x 1/2" diameter. For use with #13010 rods.

#13001 - "T" handgrip handle with 12-24 screw. 4" long x 1/2" diameter. For use with #13002 and #13003 rods.

#13002 - 24" aluminum extension rod 5/16" diameter with 12-24 male thread one end, female other. For use with 3/8" through 1" diameter condenser brushes.

#13003 - 36" aluminum extension rod 5/16" diameter with 12-24 male thread one end, female other. For use with 3/8" through 1" diameter condenser brushes.

#13010 - 36" galvanized steel condenser brush rod with 1/4-28 male thread one end and female thread at other end. For use with 1/4-28 male thread brushes.

#13041 - "T" handle with 8-32 male thread one end. For use with #13042 rods.

#13042 - 24" x .162 dia. rod, 8-32 female thread one end, male 8-32 thread other end.

#13044 - 48" x .162 dia. rod with 8-32 male thread one end, formed handle other end. For use with 1/4" and 5/16" dia. condenser brushes.

ADAPTERS

#13006 - 1/4-28 male thread to 12-24 male thread

#13008 - 1/4-28 female thread to 12-24 male thread



CLEVELAND CONTROLS AIR PRESSURE SENSING SWITCH



The model AFS-222 is a general purpose proving switch designed for HVAC and Energy Management applications. It may be used to sense positive, negative, or differential air pressure. Installation kit included. Replaces White Rodgers 770-1.

Set point range: 0.05 + .02" W.C. to 12.0" W.C.
 Operating temperature range: -40°F to 180°F
 Approvals: UL, FM, CSA

AFS-222-121

Location of Sample Lines for Typical Applications

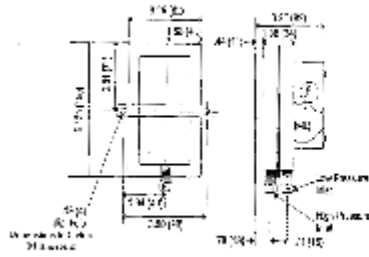
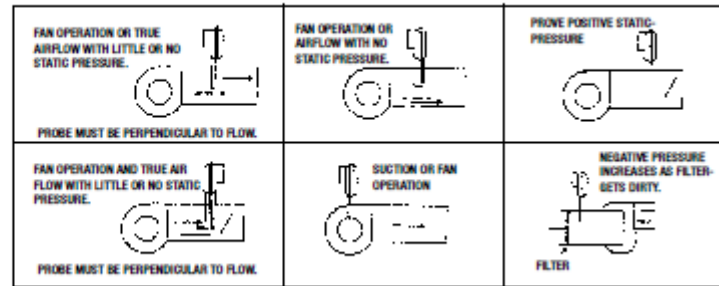

CLEVELAND CONTROLS AIR PRESSURE SENSING SWITCH

The model AFS-262 is a general purpose proving switch designed for HVAC and Energy Management applications. It may be used to sense positive, negative, or differential air pressure. Installation kit included.

Set point range: 0.05 + 0.02" W.C. to 2.0" W.C.
 Operating temperature range: -40° F to 180° F
 Approvals: UL, FM, CSA, CE

AFS-262-121

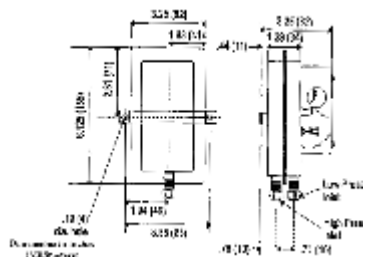

SERIES AFS SWITCHES



CLEVELAND CONTROLS AIR PRESSURE SENSING SWITCH

The NS2 series, Universal Small Footprint Air Switch, replaces hundreds of other small footprint exact replacement air switches today. Five separate springs cover ranges from .10"W.C to 10"W.C. Set screw adjustment with allen wrench included. Eight different orifice restrictors to set different time delays, and comes with two brackets for all applications.

NS2-0000-03

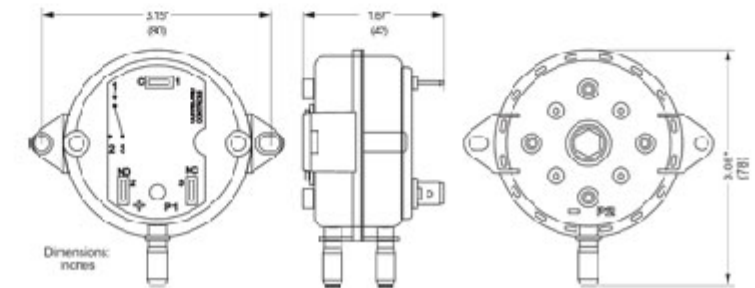
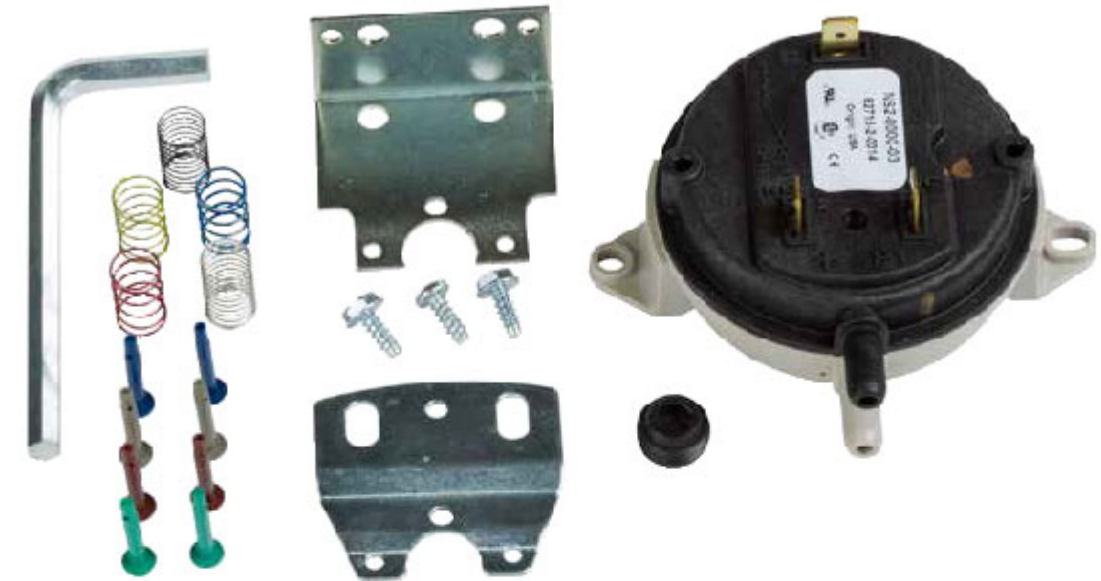



CLEVELAND CONTROLS AIR PRESSURE SENSING SWITCH KIT



Series RSS-495-11 Air Sensing Switch Kit contains compact, economical switches designed for a residential furnace and light commercial aftermarket applications. The RSS-495 switches have an adjustable set point range of 0.25" W.C. to 1.0" W.C. (they have been factory set to activate on a pressure rise of 0.25" W.C.). The field adjustability makes these switches ideal for aftermarket residential furnace applications, electronic air cleaners and humidifiers.

RSS-495-11

Adjustable range: 0.25 + 0.05" W.C. to 1.0 + 0.05" W.C.
 Operating temperature range: -40°F to 190°F
 Approvals: UL, CSA, CE, NRTL, AUST. GAS ASSOC>

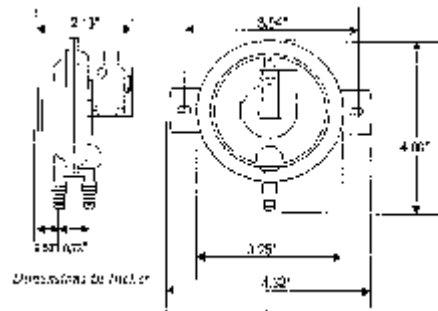

CLEVELAND CONTROLS AIR PRESSURE SENSING SWITCH KIT

Series RSS-498-13 Air Sensing Switch Kit contains compact, economical switches designed for residential furnace and light commercial aftermarket applications. The RSS-498 switches have an adjustable set point range of 1.0" W.C. to 4.0" W.C. (They have been factory set to activate on a pressure rise of 1.0" W.C.) The field adjustability makes these switches ideal for aftermarket residential furnace applications, electronic air cleaners and humidifiers.

RSS-498-13

Adjustable range: 1.0 + 0.05" W.C. to 4.0 + 0.05" W.C.
 Operating temperature range: -40° F to 180° F
 Approvals: UL, CSA, CE, NRTL, AUST. GAS ASSOC.

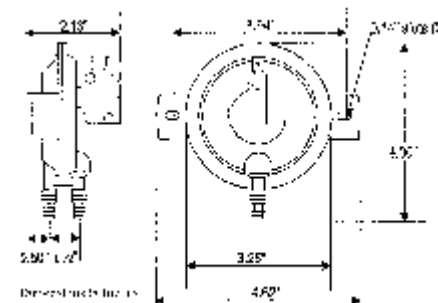

CLEVELAND CONTROLS AIR PRESSURE SENSING SWITCH WITH MANUAL RESET

The model AFS-460 is a general purpose proving switch designed to require manual operator reset following activation. It can be used to sense positive, negative, or differential air pressure in HVAC and Energy Management applications that require operator interface. Installation kit included.

EXACT OEM AVAILABLE REPLACEMENT IN 1 WEEK.



AFS-460-121

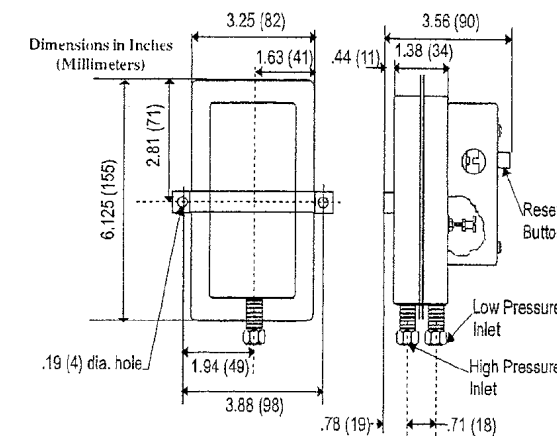

SERIES AFS SWITCHES



Square Air Switch Tubing - Silicone

Square outside prevents kinking. Easily change out corroded tubing. 5' of tubing comes in each bag. Silicone material is easy to cut to size in the field and resistant to high temperatures.

SQAST-SIL-5



Square Air Switch Tubing - Neoprene

Square outside prevents kinking. Easily change out corroded tubing. 5' of tubing comes in each bag. Neoprene material is easy to cut to size in the field

SQAST-5

Stainless Steel Vibration Absorbers

Specify ESP Vibration Absorbers in refrigeration and air conditioning systems to:

- Reduce vibration and noise
- Extend compressor life
- Allow for horizontal or vertical movement
- Relieve stress on the compressor housing
- Reduce wear on the bearings

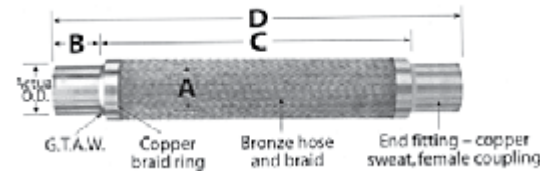

Stainless Steel Vibration Absorbers Specifications

Part Number	To Fit Copper Tube		"A" Nominal Hose I.D.	"B" Fitting Length	"D" Assembly Length	Maximum Working Pressure PSIG@70° F
	Actual O.D.	Nominal Tube				
VAB-2	1/4"	1/8"	1/4"	1/2"	7"	450
VAB-3	3/8"	1/4"	1/4"	1/2"	8-1/4"	450
VAB-4	1/2"	3/8"	3/8"	5/8"	9"	450
VAB-5	5/8"	1/2"	1/2"	7/8"	9-3/4"	450
VAB-6	3/4"	5/8"	1/2"	1"	10"	450
VAB-7	3/4"	5/8"	3/4"	1-1/8"	11-1/4"	440
VAB-8	7/8"	3/4"	3/4"	1-1/4"	11-1/2"	440
VAB-9	1-1/8"	1"	1"	1-1/2"	13"	400
VAB-10	1-3/8"	1-1/4"	1-1/4"	1-5/8"	14-3/4"	400
VAB-11	1-5/8"	1-1/2"	1-1/2"	2"	17"	400
VAB-12	2-1/8"	2"	2"	2-1/2"	20"	390
VAB-13SS	2-5/8"	2-1/2"	2-1/2"	3"	24"	340
VAB-14SS	3-1/8"	3"	3"	3-1/2"	27"	300

1. Minimum burst pressure is 5 times the maximum working pressure.
2. Hose may be helical or annular type.
3. Hose = C51000 (95/5)
Braid = C22000 (90/10)
 1. Length = D+1/4"
 2. Hose is not to be used with ammonia refrigerants

CUSHIONED TUBING CLAMPS, GALVANIZED

These channel mounted clamping systems are ideal for multiple line runs. They absorb shock and vibration, reduce unwanted noise, and prevent galvanic corrosion. The clamp features a unique shoulder stud which is securely fastened to one clamp half. This Controlled Squeeze design eliminates over-tightening and rotation while nylon insert nut assures a positive lock. Stocked with electro-dichromate finish, and available in stainless steel. The cushion is chemical resistant, and has a -50°F to 275°F operating range. A patented "Living Hinge" allows the cushion to be spread apart for quick, easy installation.

Z004T008 thru Z066N074

TUBE X PIPE O.D.

Z004T008	1/4"
Z006T010	3/8"
Z008T012	1/2"
Z010T014	5/8"
Z012T016	3/4"
Z014T018	7/8"
Z016T020	1"
Z018T022	1-1/8"
Z020T024	1-1/4"
Z022T026	1-3/8"
Z024N028	1-1/2"
Z026N030	1-5/8"
Z028N032	1-3/4"
Z030N034	1-7/8"
Z032N036	2"
Z034N040	2-1/8"
Z036N042	2-1/4"
Z038N044	2-3/8"
Z040N046	2-1/2"
Z042N048	2-5/8"
Z046N052	2-7/8"
Z050N054	3"
Z050N056	3-1/8"
Z053N060	3-5/16"
Z056N062	3-1/2"
Z058N064	3-5/8"
Z064N072	4"
Z066N074	4-1/8"



CHILLER BUILDER KIT

Chiller builder kits provide a simple solution for system installers. The systems include all of the components needed for the low side package and can be assembled in less than one hour.

TXKIT Single Circuit Standard Designs TXKIT are available in standard designs for water duty. They are available in 6 catalog models, which can be used with chiller barrels from 2 to 40 tons. The evaporator barrel is not included. All kits utilize brand name components.

TXKIT/DTXKIT Multiple Circuit Standard Designs

TXKIT/DTXKIT are available in standard designs for water duty. They are available in 9 catalog models, which can be used with evaporator barrels from 10 to 75 tons. The chiller barrel is not included. All kits utilize brand name components.

Included Components

- Control Power Supplies
- Expansion Valve
- Flow Switch
- Framework
- Freezestat
- Low Pressure Switch
- Piping
- Solenoids
- Temperature Controls

Non-Approved Refrigerants Unless Cleared by the Factory Ammonia/R717, due to copper tubing. R404A, R410A & R507A due to recommended operating pressures, custom units are available for these refrigerants.

Other Refrigerants

All other refrigerants must be approved by Standard Refrigeration/Alfa Laval before use.

Alternative Options

Kits with a supplied chiller barrel, use CBKIT. For a clean water alternative, use a BHE-KIT (brazed evaporator builder kit).

Approved Refrigerants R22, R134a.



1-Circuit

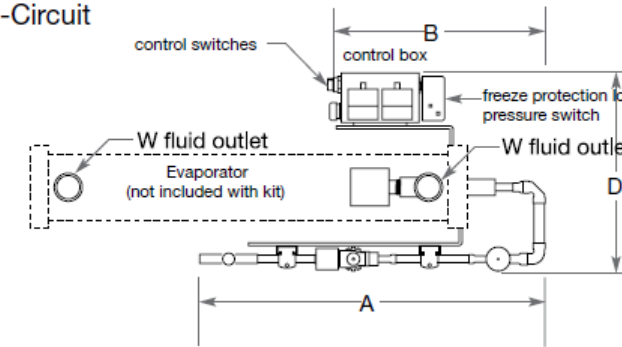

2-Circuit

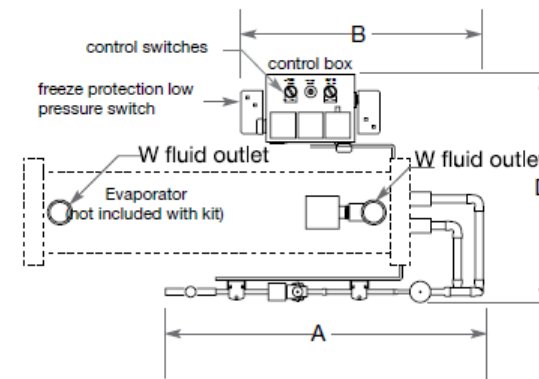

3 & 4 Circuit

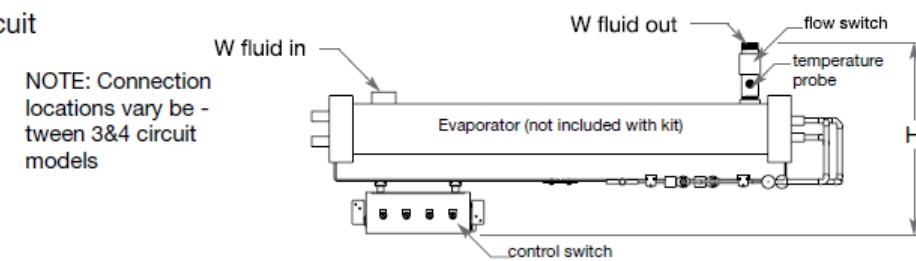

CBKIT15-3

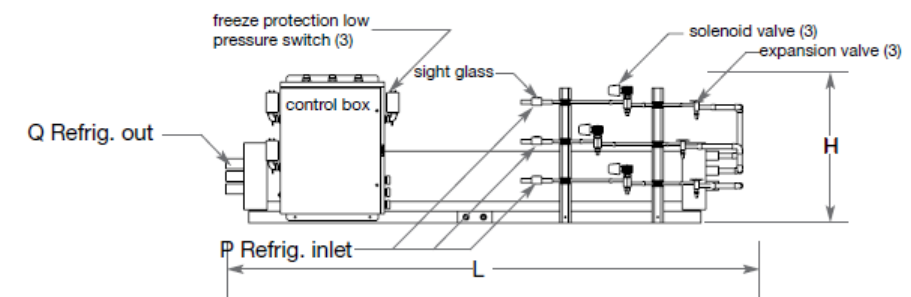

CBKIT20-4

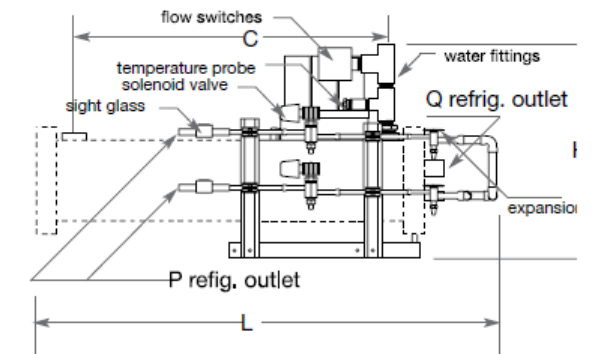
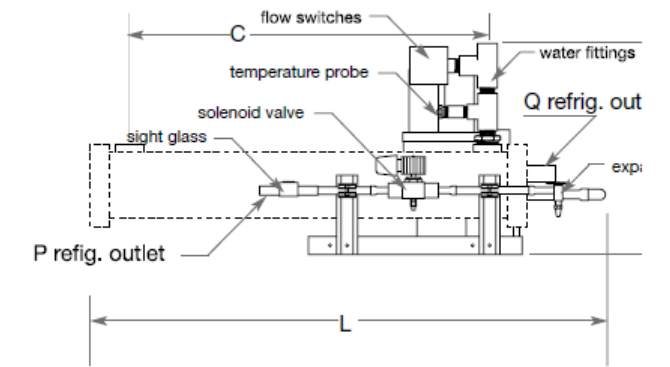
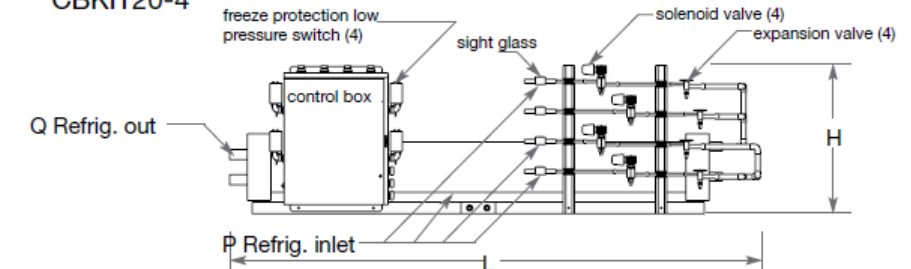

Single Circuit

Models	R22 Nominal Capacity* (tons)	Number of Circuits	Chiller Barrel Included	TX-Kit (Control pack & framework included)	Connections (inches)				Working Pressure (psi)	
					P Ref. In (IDS)	Q Ref Out (IDS)	W Fluid Conn.	T Drain (FNPT)	Shell	Tube
CBKIT2-1	2.0	1	TX2 -1	TXKIT1	5/8	7/8	1" FPT	3/8	225	225
CBKIT3-1	2.9	1	TX3 -1	TXKIT2	5/8	7/8	1" FPT	3/8	225	225
CBKIT5-1	4.9	1	TX5 -1	TXKIT2	5/8	1 1/8	1 1/4" FPT	1/2	225	225
CBKIT6-1	6.7	1	TX6 -1	TXKIT3	5/8	1 1/8	1 1/2" FPT	1/2	225	225
CBKIT7.5-1	7.6	1	TX7 1/2 -1	TXKIT3	7/8	1 5/8	1 1/2" FPT	1/2	225	225
CBKIT10-1	11.3	1	TX10 -1	TXKIT3	7/8	1 5/8	2" FPT	1/2	225	225
CBKIT12-1	14.3	1	TX12 -1	TXKIT3	7/8	1 5/8	2" FPT	1/2	225	225
CBKIT15-1***	18.3	1	TX15-1	TXKIT4	1 1/8	2 1/8	2 1/2" FPT	1/2	225	225
CBKIT20-1***	22.6	1	TX20-1	TXKIT4	1 1/8	2 1/8	3" FPT	1/2	225	225
CBKIT25-1***	27.2	1	TX25 -1	TXKIT4	1 1/8	2 5/8	3" FPT	1/2	150	225
CBKIT30-1**	29.8	1	TXC30 -1	TXKIT5	1 1/8	2 5/8	3" MPT	3/4	150	300
CBKIT40-1**	40.2	1	TXC40 -1	TXKIT6	1 3/8	2 5/8	3" MPT	3/4	150	300

*Ratings are based on entering water 54°F, leaving water 44°F, saturated suction temperature of 35°F, entering TXV temperature of 100°F with 7°F of superheating

**Kits include unloading feature, kits with no unloading feature are also available

*** Pumpdown cycle included

Chiller builder kits require 120 volt power to operate

Includes 3/4" thick insulation as standard

Values shown are correct at the time of publication, all data should be reconfirmed at the time of purchase

Capacity Tons = 12,000 BTU/hr

For performance data with other refrigerants, please call

Single Circuit

Models	Dimensions (inches)						Gaskets Article #		Heads Article #	
	A	B	C	D	H	L	Front	Rear	Inlet	Outlet
CBKIT2-1	21.00	18.25	19.75	14.00	14.00	30.25	2865	2865	3444	3451
CBKIT3-1	26.00	18.25	19.75	18.00	14.00	30.25	2865	2865	3444	3451
CBKIT5-1	26.00	18.25	31.38	18.00	16.00	42.25	2872	2872	3501	3682
CBKIT6-1	27.00	18.25	31.13	18.00	19.00	42.25	2872	2872	3501	3682
CBKIT7.5-1	27.00	18.25	31.13	18.00	19.00	42.25	4809	4816	3468	3682
CBKIT10-1	27.00	18.25	30.38	18.00	19.00	42.25	4809	4816	3468	3682
CBKIT12-1	27.00	19.38	30.13	18.00	21.00	43.25	2889	2889	3794	3701
CBKIT15-1	32.00	20.38	29.63	18.00	21.00	44.25	2889	2889	3482	3701
CBKIT20-1	32.00	20.38	29.00	18.00	21.00	44.25	2889	2889	3482	3701
CBKIT25-1	32.00	20.38	29.00	18.00	21.00	44.25	2889	2889	3532	3701
CBKIT30-1	-	-	63.00	22.00	16.00	90.00	2218	2218	21992	21985
CBKIT40-1	-	-	63.00	24.00	17.00	90.00	2227	2227	22021	22038

Dimensions do not include the 3/4" insulation

Multiple Circuit

Models	R22 Nominal Capacity* (tons)	Number of Circuits	Chiller Barrel Included	TX-Kit (Control pack & framework included)	Connections (inches)				Working Pressure (psi)	
					P Ref. In (IDS)	Q Ref Out (IDS)	W Fluid Conn.	T Drain (FNPT)	Shell	Tube
CBKIT10-2	11.3	2	TX10-2	DTXKIT10-12	5/8	1.125	2" FPT	1/2	225	225
CBKIT12-2	14.3	2	TX12-2	DTXKIT10-12	5/8	1.125	2" FPT	1/2	225	225
CBKIT15-2	18.3	2	TX15-2	DTXKIT15-20	7/8	1 5/8	2 1/2" FPT	1/2	225	225
CBKIT15-3	18.3	3	TX15-3	TXKIT15-3	5/8	1 1/8	2 1/2" FPT	1/2	225	225
CBKIT20-2	22.6	2	TX20-2	DTXKIT15-20	7/8	1 5/8	3" FPT	1/2	225	225
CBKIT20-4	22.6	4	TX20-4	TXKIT20-4	5/8	1 1/8	3" FPT	1/2	225	225
CBKIT25-2	27.2	2	TX25-2	DTXKIT15-20	7/8	1 5/8	3" FPT	1/2	150	225
CBKIT30-2**	29.8	2	TXC30-2	DTXCKIT30	7/8	1 5/8	3" MPT	3/4	150	300
CBKIT40-2**	40.2	2	TXC40-2	DTXCKIT40	1 1/8	2 1/8	3" MPT	3/4	150	300
CBKIT50-2**	50.9	2	TXC50-2	DTXCKIT50	1 1/8	2 1/8	4" FLANGE	3/4	150	300
CBKIT60-2**	59.6	2	TXC60-2	DTXCKIT60	1 1/8	2 5/8	4" FLANGE	3/4	150	300
CBKIT75-2**	75.2	2	TXC75-2	DTXCKIT75	1 3/8	2 5/8	5" FLANGE	3/4	150	300

*Ratings are based on entering water 54°F, leaving water 44°F, saturated suction temperature of 35°F, entering TXV temperature of 100°F with 7°F of superheating

**Kits include unloading feature, kits with no unloading feature are also available

*** Pumpdown cycle included

Chiller builder kits require 120 volt power to operate

Includes 3/4" thick insulation as standard

Values shown are correct at the time of publication, all data should be reconfirmed at the time of purchase

Capacity Tons = 12,000 BTU/hr

For performance data with other refrigerants, please call

Multiple Circuit

Models	Dimensions (inches)						Gaskets Article #		Heads Article #	
	A	B	C	D	H	L	Front	Rear	Inlet	Outlet
CBKIT10-2	29.00	18.25	30.38	20.00	17.00	45.25	4809	2872	3668	3675
CBKIT12-2	29.00	19.38	30.13	20.00	19.00	46.25	2889	2889	3813	3699
CBKIT15-2	29.00	19.38	29.63	20.00	21.00	46.25	2889	2889	3620	3699
CBKIT15-3	30.75	-	-	-	23.25	80.00	18696	18696	7589	7596
CBKIT20-2	29.00	19.38	29.00	20.00	21.00	46.25	2889	2889	3620	3699
CBKIT20-4	30.75	-	-	-	23.25	80.00	2889	2889	7558	7541
CBKIT25-2	29.00	19.38	29.00	20.00	21.00	46.25	2889	2889	3620	3699
CBKIT30-2	-	-	63.00	22.00	19.00	90.00	2218	2218	22014	31318
CBKIT40-2	-	-	63.00	24.00	20.00	90.00	2227	2227	22045	22052
CBKIT50-2	-	-	63.00	24.00	20.00	90.00	2227	2227	22045	22052
CBKIT60-2	-	-	73.00	24.00	22.00	104.00	2227	2227	22090	22052
CBKIT75-2	-	-	73.00	24.00	22.00	104.00	2227	2227	22119	22052

Dimensions do not include the 3/4" insulation

Chiller Builder Kits For Brazed Plate Evaporators

BUILD A COMPLETE WATER CHILLER QUICKLY AND ECONOMICALLY

CONNECTS TO YOUR CONDENSING UNIT

IMMEDIATE AVAILABILITY

Combine a Chiller Builder Kit with an Alfa Laval Brazed Plate Evaporator for a complete Low Side Chiller ready to be connected to your condensing unit. The Chiller Builder components and controls are properly matched to the evaporator, and can be used in either pump down and non-pump-down systems.

The evaporator and components are quickly assembled on the compact structural steel frame. The completed assembly can be conveniently located near the air handler or process load.

The Chiller Builder controls connect to the condensing unit thermostat terminals for simple and fool-proof installation and operation.

- Uses compact and efficient Brazed Plate Evaporators
- Available in single and dual refrigerant circuit models
- Available for R410A, R404A, R507, R22
- Brand name components
- Available in ranges from 2 to 80 tons
- Entire kit can be assembled in less than one hour
- Includes Digital Controls

Included Components

Structural Steel Framework | Electronic chiller controller with fault indicating lights | Temperature control | Electronic low pressure freeze protection switch | Expansion valve | Solenoids | Sight glass | Freezestat | Flow switch | Water strainer

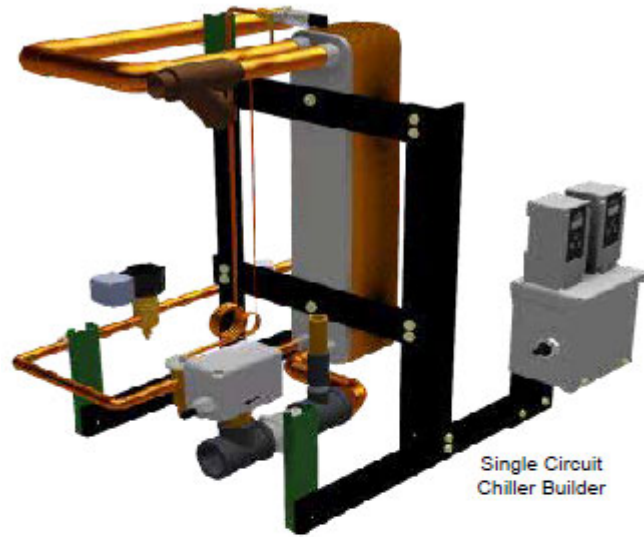

Single Circuit Chiller Builder

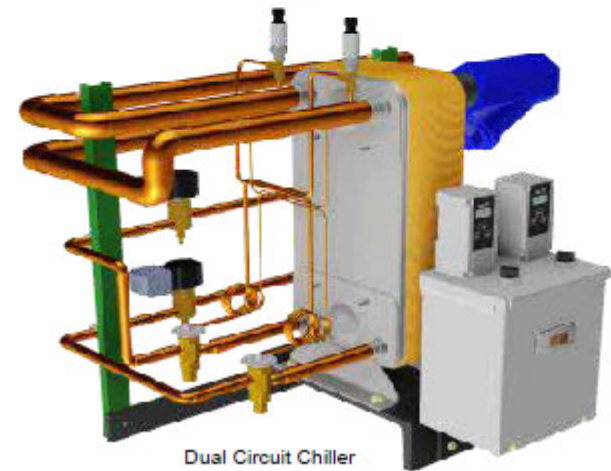

Dual Circuit Chiller

Combine a Chiller Builder Kit, BHE evaporator, and your condensing unit to create a complete water chiller ready to be piped to your cooling load.

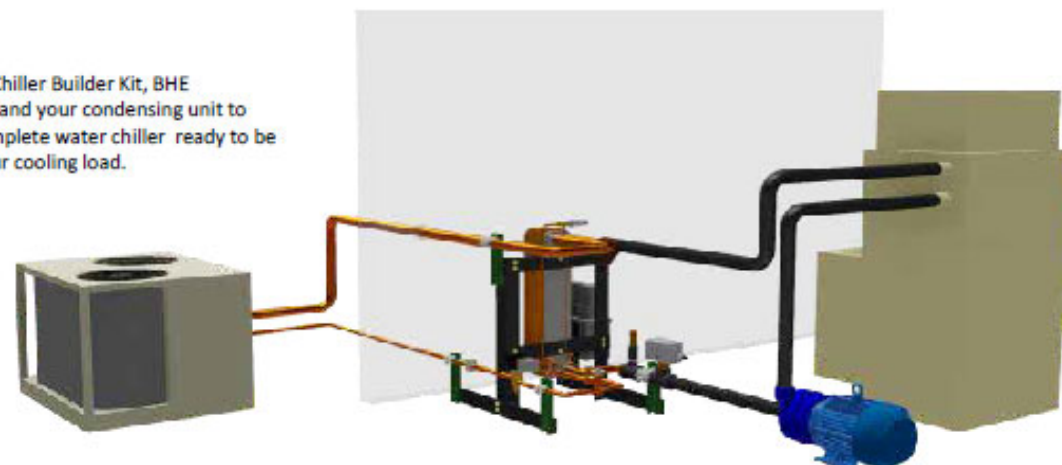

Technical specifications

Nominal Tons R410AI	Kit Model	Refrigerant		
		R410A Model	R404A / R507 Model	R22 Model
Single Refrigerant Circuit Models				
2	BHEKIT-2-1-*	ACH-30EQ-20H R52	ACH-30EQ-20H	ACH-30EQ-20H
3	BHEKIT-3-1-*	ACH-30EQ-30H S09	ACH-30EQ-30H	ACH-30EQ-30H
5	BHEKIT-5-1-*	ACH-30EQ-40H S09	ACH-30EQ-50H	ACH-30EQ-50H
7.5	BHEKIT-7.5-1-*	ACH-70X-32M S21	ACH-70X-32M	ACH-70X-42M
10	BHEKIT-10-1-*	ACH-70X-42M S24	ACH-70X-42M	ACH-70X-62M
15	BHEKIT-15-1-*	ACH-70X-62M S25	ACH-70X-62M	ACH-70X-78M
20	BHEKIT-20-1-*	ACH-70X-78M R49	ACH-70X-100M	ACH-70X-100M
25	BHEKIT-25-1-*	ACH-120EQ-46H S62	ACH-120EQ-76H	ACH-120EQ-76H
30	BHEKIT-30-1-*	ACH-120EQ-60H S62	ACH-120EQ-90H	ACH-120EQ-90H
40	BHEKIT-40-1-*	ACH-120EQ-76H S62	ACH-120EQ-124H	ACH-120EQ-124H
50	BHEKIT-50-1-*	ACH-120EQ-106H S62		
60	BHEKIT-60-1-*	ACH-120EQ-124H S62		
Dual Refrigerant Circuit Models				
10	BHEKIT10-2-*	ACH-230DQ-30H	ACH-230DQ-30H	ACH-230DQ-50H
15	BHEKIT15-2-*	ACH-230DQ-50H	ACH-230DQ-50H	ACH-230DQ-50H
20	BHEKIT20-2-*	ACH-230DQ-50H	ACH-230DQ-70H	ACH-230DQ-70H
25	BHEKIT25-2-*	ACH-230DQ-70H	ACH-230DQ-70H	ACH-230DQ-70H
30	BHEKIT30-2-*	ACH-230DQ-70H	ACH-230DQ-90H	ACH-230DQ-90H
40	BHEKIT40-2-*	ACH-230DQ-90H	ACH-230DQ-110H	ACH-230DQ-110H
50	BHEKIT50-2-*	ACH-230DQ-110H	ACH-230DQ-138H	ACH-230DQ-138H
60	BHEKIT60-2-*	ACH-230DQ-138H	ACH-230DQ-138H	ACH-230DQ-138H
80	BHEKIT80-2-*	ACH-230DQ-170H	ACH-230DQ-202H	ACH-230DQ-202H

* -Refrigerant, e.g., The model number of a nominal 10 ton single circuit kit for R410A will be BHEKIT-10-1-410.
 ** Based on R410A. Contact factory for other refrigerant and water line sizes.

Assembled Kit Dimensions

Nominal Tons R410AI	Kit Model	L Length	W Width	H Height	W** Water conn. (ids)	P** Liquid conn. (ids)	Q** Suction conn. (ids)	Kit Weight lbs.***
Single Refrigerant Circuit Models								
2	BHEKIT-2-1-*	32"	24"	19"	7/8"	3/8"	7/8"	40
3	BHEKIT-3-1-*	32"	24"	19"	7/8"	3/8"	7/8"	45
5	BHEKIT-5-1-*	32"	24"	19"	7/8"	3/8"	7/8"	45
7.5	BHEKIT-7.5-1-*	34"	25"	28"	1-1/8"	5/8"	1-1/8"	65
10	BHEKIT-10-1-*	34"	25"	28"	1-1/8"	5/8"	1-1/8"	65
15	BHEKIT-15-1-*	34"	25"	28"	1-1/8"	5/8"	2-1/8"	70
20	BHEKIT-20-1-*	34"	25"	28"	1-3/8"	7/8"	2-1/8"	75
25	BHEKIT-25-1-*	38"	31"	34"	2-1/8"	7/8"	2-1/8"	115
30	BHEKIT-30-1-*	38"	31"	34"	2-1/8"	1-1/8"	2-1/8"	115
40	BHEKIT-40-1-*	38"	31"	34"	2-1/8"	1-1/8"	2-1/8"	125
Dual Refrigerant Circuit Models								
10	BHEKIT10-2-*	40"	22"	30"	2" Victaulic	3/8"	1-1/8"	90
15	BHEKIT15-2-*	40"	22"	30"	2" Victaulic	5/8"	1-3/8"	90
20	BHEKIT20-2-*	40"	22"	30"	2" Victaulic	5/8"	1-3/8"	90
25	BHEKIT25-2-*	44"	22"	32"	2" Victaulic	5/8"	1-3/8"	95
30	BHEKIT30-2-*	48"	24"	32"	2" Victaulic	7/8"	1-3/8"	95
40	BHEKIT40-2-*	50"	24"	32"	2½" Victaulic	7/8"	1-5/8"	125
50	BHEKIT50-2-*	53"	24"	34"	2½" Victaulic	7/8"	1-5/8"	125
60	BHEKIT60-2-*	53"	24"	34"	2½" Victaulic	1-1/8"	2-1/8"	140
80	BHEKIT80-2-*	60"	26"	34"	2½" Victaulic	1-1/8"	2-1/8"	140

* -Refrigerant, e.g., The model number of a nominal 10 ton single circuit kit for R410A will be BHEKIT-10-1-410.

*** Does not include the weight of evaporator.

PART NUMBER INDEX

00402	70
00403	70
00405	70
00406	70
00408	70
00415	70
00442	70
00450	70
722	16
729	16
02026	74
6952	38
6953	38
6954	38
6955	38
6956	38
10001	73
10002	73
10003	73
10007	73
10209	68
10210	68
10211	68
10212	68
10213	68
10214	68
10216	68
10217	68
10218	68
10220	68
10221	68
10222	68
10223	68
10224	68
10225	68
10226	68
13000	81
13001	81
13002	81
13003	81
13006	81
13008	81
13010	81
13041	81
13042	81
13044	81

14402	69
14404	69
14406	69
14408	69
14410	69
14412	69
14414	69
14416	69
14418	69
14442	69
14444	69
14446	69
14448	69
14450	69
14452	69
14454	69
14456	69
14458	69
14465	80
14466	80
14467	80
14468	80
14476	80
14477	80
14504	68
14506	68
14509	68
14510	68
14512	68
14515	68
14517	68
14518	68
14520	68
14524	68
14529	68
14530	68
14533	68
14539	68
14547	68
14565	68
14567	68
14573	68
14582	68
14588	68
24800	74
25010	75
25013	75

25015	75
25301	76
25302	76
25404	76
25405	76
25406	76
25407	76
27668	77
27698	77
30200	12
30328	78
30438	78
30548	78
30599	78
30600	78
30658	78
30660	78
30664	78
30666	78
31438	78
31448	78
31458	78
33066	77
33076	77
33086	77
33096	77
33106	77
33116	77
33126	77
33266	77
33277	77
33288	77
33299	77
33310	77
33311	77
33312	77
33314	77
36048	78
36072	78
40437	15
41218	80
41228	80
41238	80
41248	80
43206	79
43208	79
43212	79

43214	79
43216	79
43218	79
43222	79
43224	79
43226	79
43228	79
43232	79
43234	79
43236	79
43238	79
43306	79
43308	79
43312	79
43314	79
43316	79
43318	79
43322	79
43324	79
43326	79
43328	79
43332	79
43334	79
43336	79
43338	79
43536	79
43539	79
43542	79
43545	79
43548	79
43551	79
43553	79
43556	79
43559	79
43562	79
43565	79
43568	79
43571	79
43573	79
43576	79
43579	79
43636	69
43639	69
43642	69
43645	69
43648	69
43651	69

43653	69
43656	69
43658	69
43660	69
43662	69
43664	69
43736	69
43739	69
43742	69
43745	69
43748	69
43751	69
43753	69
43756	69
43758	69
43760	69
43762	69
43764	69
46302	80
46304	80
46328	80
46348	80
55104	76
55105	76
62034	74
65341	76
66517	37
66518	37
66519	37
66520	37
66551	37
66552	37
66553	37
66554	37
66587	37
66588	37
66590	37
67118	74
67191	73
67192	73
67193	73
67194	73
67195	73
67196	73
67197	73
67230	73
67231	73

PART NUMBER INDEX

67232	73
67233	73
67234	73
67235	73
67240	75
67241	75
67242	75
67243	75
67244	75
67245	75
76026	71
76200	70
76210	70
76220	70
76221	71
76243	70
76252	80
76253	80
76254	80
76255	80
76256	80
76257	80
76258	80
76324	71
76524	71
81002	77
81003	77
81005	77
81006	77
81008	76
81009	76
81010	76
81018	76
81020	76
81025	76
81044	76
81045	76
81232	75
81233	75
81234	75
81616	74
81617	74
93490	81
93491	81
93492	81
121071	4
240116	15

PART NUMBER INDEX

240117	15
384110	36
429762	36
666589	37
3838506	36
3838508	36
3838509	36
3843043	36
00925-1	67
00926-1	67
00927-1	67
00928-1	67
00929-1	67
00930-1	67
00931-1	67
00932-1	67
00933-1	67
00934-1	67
00935-1	67
00936-1	67
00937-1	67
00943-1	67
00944-1	67
00945-1	67
00947-1	67
00948-1	67
00949-1	67
00950-1	67
00951-1	67
00952-1	67
00953-1	67
00954-1	67
00963-6	68
00964-6	68
00965-6	68
00966-6	68
00967-6	68
00968-6	68
00969-6	68
00996-12	68
00998-100	68
00998-12	68
012-DC	12
07-012 / 08-012	23
07-034 / 08-034	23
07-100 / 08-100	23
10-212	12

10-219	12
10T	59
132ME	16
15-012 / 16-012	22
15-014	22
15-034 / 16-034	22
15-038	22
15-100 / 16-100	22
15-114 / 16-114	22
1A	44
2006-34	65
2006-38	65
2007-31	65
2007-33	65
2007-41	65
2007-44	65
2026-14	65
20T	59
20T1	59
221-2401	54
221-2401/K000-0004	54
221-412	54
221-412/996-010	54
221-413	54
221-413/996-010	54
221-415	54
221-415/996-010	54
263-R	51
2B	44
30T	59
30T1	59
3C	44
40T	59
40T1	59
40T2	59
43482/93482	81
43484/93484	81
43486/93486	81
43502/93502	72
43503/93503	72
43504/93504	72
43507/93507	72
43510/93510	72
43513/93513	72
43516/93516	72
43519/93519	72
43522/93522	72

43525/93525	72
43531/93531	72
43533/93533	72
43602/93602	72
43603/93603	72
43604/93604	72
43607/93607	72
43610/93610	72
43613/93613	72
43616/93616	72
43619/93619	72
43622/93622	72
43625/93625	72
43628/93528	72
43628/93628	72
43631/93631	72
43633/93633	72
43702/93702	71
43703/93703	71
43704/93704	71
43707/93707	71
43710/93710	71
43713/93713	71
43716/93716	71
43719/93719	71
43722/93722	71
43725/93725	71
43728/93728	71
43731/93731	71
43733/93733	71
50T	59
522-0024-24	66
522-0024-36	66
533-0024-24	66
533-0024-36	66
58-012/ 59-012	23
58-014 / 59-014	23
58-034 / 59-034	23
58-038 / 59-038	23
58-100 / 59-100	23
58-114 / 59-114	23
60-012	22
60-034	22
60T	59
60T4	59
6773-02	38
6773-03	38

6773-04	38
6773-05	38
6884-06	38
6884-40	38
7757WC	3
810-C	46
8732A	1
8732A3	1
8732B	1
8732B3	1
8732C	1
8732C3	1
8732W	1
8732W3	1
8736R	1
90T	59
A0120D100	31
A0340D114	31
A0580D100	31
A0780D114	31
A0780D114M	32
A10WPR	42
A1180D114	31
A1180D134	31
A1180D134M	32
A12WPR	42
A1380D134	31
A35WPR	42
AA0120D100	32
AA0380D100	32
AA0580D100	32
AA0780D114	32
AA1180D114	32
AA1380D134	32
AB10	58
ABC10-R	51
ABC12-R	51
ABC15-R	51
ABC1-R	51
ABC20-R	51
ABC2-R	51
ABC30-R	51
ABC3-R	51
ABC4-R	51
ABC5-R	51
ABC6-R	51
ABC8-R	51

ABSP25	4
AC&RA	1
AC&RB	1
AC&RC	1
AC&RW	1
AFS-222-121	82
AFS-262-121	82
AFS-460-121	85
AGC1/2-R	51
AGC1/4-R	51
AGC1/8-R	51
AGC10-R	51
AGC1-1/2-R	51
AGC12-R	51
AGC15-R	51
AGC1-6/10-R	51
AGC1-R	51
AGC20-R	51
AGC2-1/2-R	51
AGC25-R	51
AGC2-R	51
AGC3/4-R	51
AGC3/8-R	51
AGC30-R	51
AGC3-R	51
AGC4-R	51
AGC5-R	51
AGC6-R	51
AGC8-R	51
AGX1	51
AGX1/4	51
AGX2	51
AGX2-1/2	51
AGX3	51
AGX3/8	51
AGX4	51
AGX5	51
ALDP	45
AP12	8
AP14	8
ATC1	55
ATC10	55
ATC15	55
ATC2	55
ATC20	55
ATC25	55
ATC3	55

ATC30	55
ATC4	55
ATC40	55
ATC5	55
ATC7-1/2	55
ATM3	53
ATM5	53
AW12	13
AW58	13
BH1	18
BRT10	18
BS30	58
BUCKET-5GR	41
BUCKETLID	41
BUCKETSEAT	41
BURCKET-5GW	41
BX50	60
BY12	19
BY34	19
CC100	9
CC12	9
CGR10	17
C-1K55-A020	19
CO2-100	25
CO2-12	25
CO2-12T	25
CO2-20-100	25
CO2-20-12	25
CR32	60
CTB25	40
CV-2 DVS	63
CV-3 DVS	63
DLG-1	25
DLG-2	25
DVS-2	63
DVS-3	63
DVS-4	63
EATC3-25	53
EATC5-25	53
EC-200	50
EL10	11
EP2	3
FA6060	47
FB100	13
FF75	10
FG12	50
FLEXB-6	24

PART NUMBER INDEX

FLEXCON1	24
FLEXCON125	24
FLEXCON125150	24
FLEXCON150	24
FLEXCON2	24
FLEXCON23	24
FLEXCON3	24
FLEXCON34-6	24
FLEXCON-BULK	24
FM222	3
FP2	55
FP3	55
FRNR10	52
FRNR100	52
FRNR12	52
FRNR125	52
FRNR15	52
FRNR150	52
FRNR175	52
FRNR2	52
FRNR20	52
FRNR200	52
FRNR2-1/2	52
FRNR225	52
FRNR25	52
FRNR30	52
FRNR35	52
FRNR4	52
FRNR40	52
FRNR45	52
FRNR5	52
FRNR50	52
FRNR5-6/10-	52
FRNR60	52
FRNR6-1/4	52
FRNR70	52
FRNR8	52
FRNR80	52
FRNR90	52
FRSR10	52
FRSR100	52
FRSR12	52
FRSR15	52
FRSR175	52
FRSR2	52
FRSR20	52
FRSR25	52

FRSR30	52
FRSR3-2/10	52
FRSR35	52
FRSR40	52
FRSR45	52
FRSR5	52
FRSR50	52
FRSR60	52
FRSR70	52
FRSR8	52
FRSR80	52
FRSR9	52
FRSR90	52
FS1000	49
FS3000	49
FS5000	49
FS7000	49
FS9000	49
FSCM00	49
FW1701	16
G325A	7
GB10	34
GS516	13
H012FL034D	27,28
H012FL034T	27,28
H012FL100D	27,28
H012FL100T	27,28
H012OD100D	27,28
H012OD100T	27,28
H034OD114D	27,28
H034OD114T	27,28
H038FL034T	27,28
H038FL100D	27,28
H038OD034T	27,28
H038OD100D	27,28
H058FL100D	27,28
H058FL100T	27,28
H058OD100D	27,28
H058OD100T	27,28
H058OD114D	27,28
H078OD114D	27,28
H078OD114T	27,28
H078OD134D	27,28
H118OD114T	27,28
H118OD134T	27,28
H118OD14D	27,28
H118OD14D	27,28

H138OD134T	27,28
H138OD14D	27,28
HB34	50
HC12-100	57
HC12-25	57
HC12-50	57
HC14-100	57
HC14-25	57
HC14-50	57
HD32	59
HG-501A	50
HP215	19
HP510-115	19
HPCH	63 & 65
HPCH18	67
HPCH24	67
HPCH30	67
HPCH36	67
HPCH48	67
HPHK	65
HRK	55
HVACSC-1	64
HVN1	62
IS005	60
KTK30	51
KTKR1	51
KTKR10	51
KTKR15	51
KTKR20	51
KTKR25	51
KTKR3	51
KTKR30	51
KTKR3-1/2	51
KTKR4	51
KTKR5	51
KTKR6	51
LD10	20
LDF357N-MPT	19
LDF359N-MPT	19
LW601	14
MDL10-R	51
MDL1-2/10-R	51
MDL15-R	51
MDL1-R	51
MDL20-R	51
MDL2-R	51
MDL30-R	51

MDL3-R	51
MDL4-R	51
MDL5-R	51
MDL6-R	51
MDL7-R	51
MDL8-R	51
NS2-0000-03	83
NT02	10
P30002	5
P30002	5
P30033	5
P30181	5
PB12-100	57
PB12-25	57
PB12-50	57
PB14-100	57
PB14-25	57
PB14-50	57
PB16	6
PC100	8
PC12	8
PC14	7
PCL DISPLAY	21
PCL12	21
PCL14	21
PCL38	21
PCL58	21
PD12-2	57
PE44	17
PG100	7
PG14	8
PH10	16
POP10	11
POP15	11
POP20	11
POP3	11
POP3Z	11
POP5	11
POP5Z	11
PP100	8
PP12	8
PP14	5
PS621	9
PUP63	7
PY38	19
QB1	20
QBA	20

RAD2	76
RC034-2	32
RC100-2	32
RC114-2	32
RC134-1	32
RH-10	18
RHB-82	48
RHB-82G	48
RS10	14
RS100	57
RS15	14
RS21	14
RS31	14
RS60	57
RS75	57
RSS-495-11	84
RSS-498-13	84
S10	52
S15	52
S2	52
S20	52
S210	52
S25	52
S3	52
S30	52
S3-1/2	52
S3-2/10	52
S4	52
S5	52
S6-1/4	52
S8	52
SB30	39
SB72	39
SB72CD	39
SC1	52
SC10	52
SC15	52
SC2	52
SC20	52
SC25	52
SC3	52
SC30	52
SC35	52
SC4	52
SC40	52
SC45	52
SC5	52

SC50	52
SC6	52
SC60	52
SDT-25S	44
SE004	44
SE008	44
SE150	44
SE45	44
SGRT	18
SH12KIT	66
SH12Y	66
SH18KIT	66
SH18Y	66
SL20	52
SL25	52
SL30	52
SQAST-5	87
SQAST-SIL-5	87
SSU	55
SSY	55
ST1236-31	45
T10	52
T1-1/4	52
T12	52
T15	52
T1-6/10	52
T2	52
T2-/12	52
T20	52
T25	52
T30	52
T3-1/2	52
T3-2/10	52
T4	52
T4-1/2	52
T5	52
T6-1/4	52
T8	52
TECK50	63
TG007	58
TGII	59
TL15	52
TL20	52
TL25	52
TL30	52
TLFL	56
TP01CL	63

PART NUMBER INDEX

PART NUMBER INDEX

TP02CL	63
TP03CL	63
TP04CL	63
TP06M	63
TP07M	63
TP08M	63
TP35	49
TP50	49
TR034-6	34
TR100-6	34
TR10-12	34
TR114-6	34
TR134-6	34
TS32	59
TT10	56
TT260	9
TT520	9
TTUL260	9
TTUL520	9
UD12	46
UHS120	43
UHS24	43
UHS99	43
V0120D100D	29
V0120D100T	29
V0380D034D	29
V0580D100D	29
V0580D100T	29
V0780D114D	29
V0780D114T	29
V1180D114D	29
V1180D114T	29
V1380D134T	29
VAB-10	86
VAB-11	86
VAB-12	86
VAB-13SS	86
VAB-14SS	86
VAB-2	86
VAB-3	86
VAB-4	86
VAB-5	86
VAB-6	86
VAB-8	86
VAB-9	86
VM116B	2
VM116G	2

VM116W	2
VP24	10
VR-554	36
WC05	40
WC10	40
WDRG 10 3	6
WDRG GAL	6
WF310	5
XHP222	3
XT150	2
XT250	2
Z004T008	87
Z006t010	87
Z008T012	87
Z010T014	87
Z012T016	87
Z014T018	87
Z016T020	87
Z018T022	87
Z020T024	87
Z022T026	87
Z024N028	87
Z026N030	87
Z028N032	87
Z030N034	87
Z032N036	87
Z034N040	87
Z036N042	87
Z038N044	87
Z040N046	87
Z042N048	87
Z046N052	87
Z050N056	87
Z053N060	87
Z056N062	87
Z058N064	87
Z064N072	87
Z066N074	87
ZT10	17

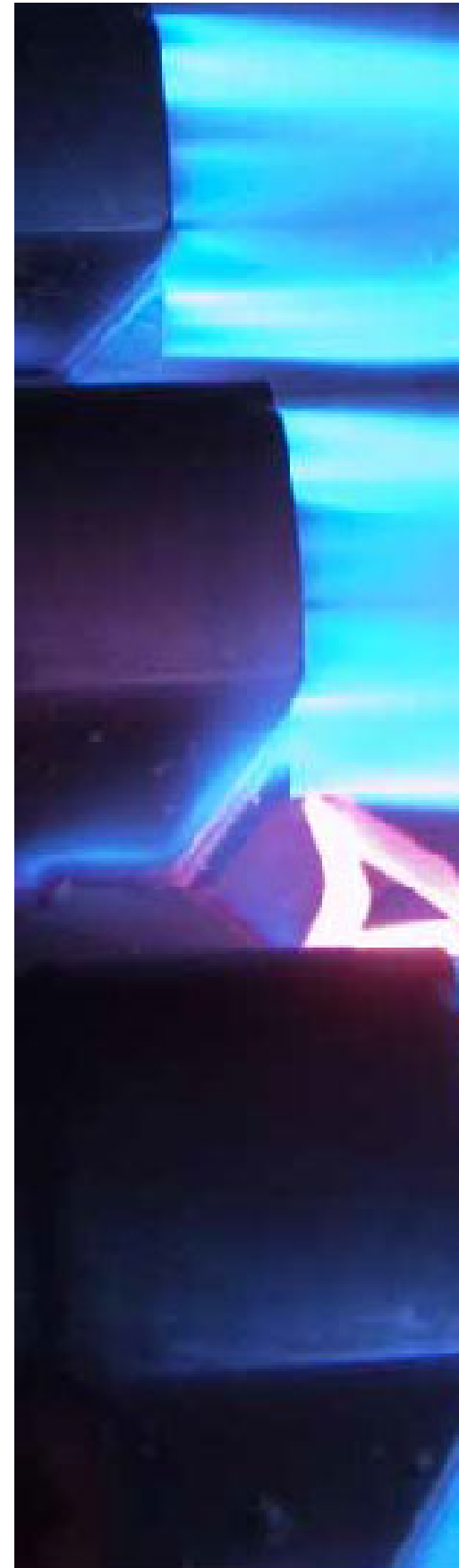

PO Box 391
 Vandalia, OH 45377
 (937) 898-0391
www.espcompany.com